

TIPPMANN

INDUSTRIAL PRODUCTS, INC.

CLICKER OPERATOR'S MANUAL



**7 TON
CLICKER**

AIR OPERATED DIE CUTTING MACHINES

15 TON CLICKER



rev. 7-2018

TIPPMANN

INDUSTRIAL PRODUCTS, INC.

3518 ADAMS CENTER RD. • FORT WAYNE IN, 46806

TOLL FREE: 866-286-8046

www.tippmannclicker.com

Congratulations on your purchase of the Tippmann Clicker Air Powered die cutting machine. Please take time to read through this operators manual thoroughly and become familiar with the Tippmann Clicker parts, operation and safety precautions before attempting to operate

CLICKER OPERATORS MANUAL

CONTENTS

TABLE OF CONTENTS.....	1
WARNING LIABILITY STATEMENT.....	2
SAFETY.....	2
GENERAL DESCRIPTION AND SPECIFICATIONS: CLICKER 700.....	3
GENERAL DESCRIPTION AND SPECIFICATIONS: CLICKER 1500.....	3
SET UP INSTRUCTIONS.....	4
OPERATIONS AND MAINTENANCE.....	5
ADJUSTING CUTTING DEPTH.....	6-7
TROUBLE SHOOTING.....	8
CUSTOM DIE SERVICE.....	9
WARRANTY AND REPAIR.....	10
CLICKER 1500 SCHEMATIC.....	12-13
CLICKER 700 SCHEMATIC.....	14-15
ADDITIONAL CLICKER ACCESSORIES.....	16-17

WARNING

PLEASE TAKE TIME TO READ THROUGH THIS MANUAL THOROUGHLY AND BECOME FAMILIAR WITH THE TIPPMANN CLICKER PARTS, OPERATION, AND SAFETY PRECAUTIONS BEFORE YOU ATTEMPT TO OPERATE THIS MACHINE.

WARNING LIABILITY STATEMENT

This Tippmann CLICKER die cutting machine is surrendered by Tippmann Industrial Products, Inc., with the understanding that the purchaser assumes all liability resulting from unsafe operation. Tippmann Industrial Products, Inc., shall not be liable for personal injury resulting from the use of this machine under any circumstances.

All information in this manual is subject to change without notice and in no way represents a commitment on the part of Tippmann Industrial Products, Inc. We reserve the right to make changes and improvements to products without incurring any obligation to incorporate such improvements in products previously sold.

WARNING

PLEASE TAKE TIME TO READ THROUGH THIS MANUAL THOROUGHLY AND BECOME FAMILIAR WITH THE TIPPMMANN CLICKER PARTS, OPERATION, AND SAFETY PRECAUTIONS BEFORE YOU ATTEMPT TO OPERATE THIS MACHINE.

SAFETY IS YOUR RESPONSIBILITY!

The ownership of this machine places upon you the total responsibility of its safe operation. You must observe the same safety precautions as you would any piece of equipment to assure the safety of not only yourself but everyone around you.

Outlined here are some general precautions to be aware of; ***the operator should at all times use common sense when using this machine and be sure others who may operate are also familiarized, responsible and safety conscious.*** Do not attempt to operate this machine until you have read and are familiar with this manual.

- Shut off air supply and cycle the machine to remove pressurized air:**
 - Before moving machine.
 - Before disassembly of machine.
 - Before changing cutting bed.
 - Before adjusting die cutting bed.
- Do not attempt to operate this machine until it is securely positioned on a sturdy work surface.
- Do not operate this machine in any position except positioned securely on a sturdy work surface.
- Do not operate this machine when parts have been removed as damage to the machine and/or injury to operator may result.
- Keep hands clear of die mold blades and cutting board area at all times.
- Never attempt to override the Dual Palm Buttons.

GENERAL DESCRIPTION

The Tippmann Clicker is an air operated die cutting machine.

The Tippmann Clicker is designed and built to achieve precision quality die cutting of leather, fabric, gasket material, plastic, textiles, etc.

using Steel Rule Dies, Forged Dies or Clicker Dies.

"CLICKER" 7 TON



"CLICKER" 15 TON



CLICKER 7 TON - SPECIFICATIONS:

Make	Tippmann
Model	CLICKER 7 TON
Cutting Pressure	7 Ton
Cutting Beam	12" x 12"
Cutting Area	11.875" x 11.875"
Recommended Die Height('s).....	.937" & 1.25"
Maximum Material Thickness75"
Daylight.....	.2.5"
Approximate Shipping Weight.....	.260 lbs.
Operating Pressure.....	80-110 PSI
Overall Dimensions	12"W x 19"x 13"H

CLICKER 15 TON - SPECIFICATIONS:

Make	Tippmann
Model	CLICKER 15 TON
Cutting Pressure	15 Ton
Cutting Beam	12" x 24"
Cutting Area	11.875" x 23.875"
Recommended Die Height('s).....	.937" & 1.25"
Maximum Material Thickness75"
Daylight.....	.2.5"
Approximate Shipping Weight.....	.520 lbs.
Operating Pressure.....	80-110 PSI
Overall Dimensions	25"W x 20" x 14"H

SETUP INSTRUCTIONS

! WARNING

CAREFULLY REMOVE THE TIPPMANN CLICKER FROM THE SHIPPING CONTAINER. THE TIPPMANN CLICKER 700 WEIGHS APPROXIMATELY 260 LBS. AND THE TIPPMANN CLICKER 1500 WEIGHS APPROXIMATELY 560 LBS. CARE SHOULD BE TAKEN TO HAVE SUFFICIENT HELP AVAILABLE WHEN MOVING EITHER, TO PREVENT PERSONAL INJURY OR DAMAGE TO THE EQUIPMENT. THE CLICKER SHOULD BE PLACED ON A STURDY WORKBENCH CAPABLE OF SUPPORTING ITS WEIGHT AND THE ACTIVITIES ASSOCIATED WITH ITS OPERATION.

CONNECT THE AIR SUPPLY

Connect the air supply to the Clicker air supply 1/4" quick connect fitting and the Clicker is operational

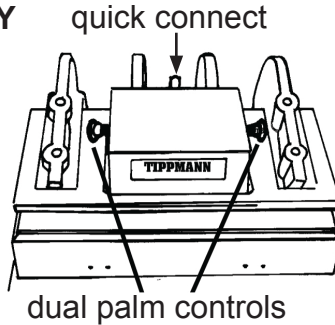

**Optimal operating pressure for this press is 110 PSI.
Do not exceed 120 PSI.**

PERFORMANCE TIP

While the Tippmann Clicker will provide excellent performance on a typical workbench, we have found that a table built up to the same height of the cutting surface allows you to slide material in and out of the Clicker with ease.

The following Tippmann Products are specifically designed to do this.

HEAVY DUTY TABLE

Provides a raised work surface which enhances your productivity by enabling you to slide material in and out of the Clicker with ease.

For 15 TON CLICKER



For 7 TON CLICKER



OPERATION AND MAINTENANCE

WARNING

THE OPERATOR SHOULD AT ALL TIMES USE COMMON SENSE WHEN USING THIS MACHINE AND BE SURE OTHERS WHO MAY OPERATE IT ARE ALSO FAMILIARIZED, RESPONSIBLE AND SAFETY CONSCIOUS. ALWAYS DOUBLE CHECK TO BE SURE THERE IS NOTHING IN THE CUTTING BED THAT SHOULD NOT BE, E.G. HANDS, TOOLS. DO NOT ATTEMPT TO OPERATE THIS MACHINE UNTIL YOU HAVE READ AND ARE FAMILIAR WITH THIS MANUAL.

HOW TO OPERATE.

You can use the Tippmann Clicker Press with the die on the bottom facing die blade up or your die on the top facing die blade down

- If you are using the **die on the bottom**, facing **die blade up**, be sure to mount your HDPE cutting board (provided with the machine) on the top.
- If you are using the **die on the top**, facing **die blade down**, be sure to put your HDPE cutting board (provided with the machine) on the bottom.

NOTE: THE HDPE cutting board is a sacrificial surface and will become worn over time. When it comes to replace the board, be sure to use the appropriate replacement board.

- If using a .937" die use a .813" cutting board
- If using a 1.25" die use a .5" cutting board
- If using a 1.5" die use a .25" cutting board

MAINTENANCE

Keep the Tippmann Clicker clean. We recommend using an air compressor with a moisture filter or dryer to alleviate moisture build up in the Clicker Press.

BOTTOM VIEW OF 7 TON

(Bottom View of model 700 shown)
Cutting Bed Adjustment
Bolts (4)

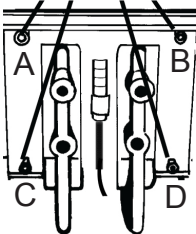

BOTTOM VIEW 15 ton

(Bottom View of model 1500 shown)
Cutting Bed Adjustment
Bolts (4)

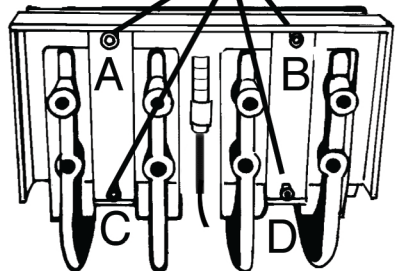

ADJUSTING THE CUTTING DEPTH 1500 PRESS

WARNING

DISCONNECT THE MACHINE FROM AIR SUPPLY AND CYCLE THE CLICKER TO EXHAUST ANY REMAINING PRESSURIZED AIR FROM THE MACHINE. BE SURE TO HAVE SUFFICIENT HELP WHEN MOVING THE MACHINE AS THE CLICKER 700 WEIGHS APPROXIMATELY 260 LBS. AND THE CLICKER 1500 WEIGHS APPROXIMATELY 560 LBS. AND IF EITHER WERE ALLOWED TO SHIFT UNEXPECTEDLY IT COULD CAUSE PERSONAL INJURY OR EQUIPMENT DAMAGE. READ THIS MANUAL AND AT ALL TIMES USE COMMON SENSE WHEN USING THIS MACHINE. BE SURE OTHERS WHO MAY OPERATE OR PERFORM MAINTENANCE HAVE ALSO READ THIS MANUAL AND ARE RESPONSIBLE AND SAFETY CONSCIOUS.

The Cutting bed is adjusted at the factory to allow the use of either .937" cutting dies or 1.25" cutting dies.

• If the blade does not penetrate through the material an adjustment may be necessary.

(Bottom View of model 1500 shown)
Cutting Bed Adjustment Bolts (4)

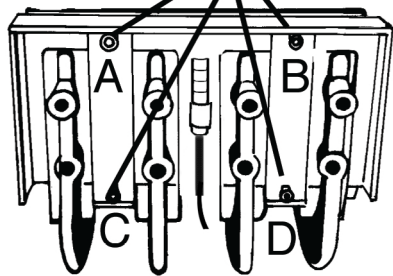

To adjust the cutting depth of the machine:

1. Disconnect the air supply to the Clicker.
2. Cycle the Clicker to exhaust any remaining pressurized air.
3. Read and adhere to the above Safety Precautions.
4. Locate the 4 cutting deck adjustment nuts on the bottom of the Clicker. (a, b, c, d - above)
5. Loosen the locking nut on bolt "a".
 - Turn out counterclockwise 1/4 turn. (This will move the deck approximately 1/64" deeper into the cutting bed.)
 - Tighten the locking nut on "a".
6. Loosen the locking nut on bolt "b".
 - Turn bolt "b" out counterclockwise 1/4 turn.
 - Tighten the locking nut on "b".
7. Loosen the locking nut on bolt "c".
 - Turn bolt "c" out counterclockwise 1/4 turn.
 - Tighten the locking nut on "c".
8. Loosen the locking nut on bolt "d".
 - Turn bolt "d" out counterclockwise 1/4 turn.
 - Tighten the locking nut on "d".
9. Return Clicker to a secure position on a sturdy workbench.
10. Reconnect Clicker to air supply and run test cut to confirm that proper depth has been achieved. Repeat as necessary.

NOTE: IT MAY NOT BE NECESSARY TO ADJUST ALL (4) BOLTS. ADJUST ACCORDING TO WHAT SECTION OF YOUR PRESS IS NOT CUTTING.

ADJUSTING THE CUTTING DEPTH 700 PRESS

WARNING

DISCONNECT THE MACHINE FROM AIR SUPPLY AND CYCLE THE CLICKER TO EXHAUST ANY REMAINING PRESSURIZED AIR FROM THE MACHINE. BE SURE TO HAVE SUFFICIENT HELP WHEN MOVING THE MACHINE AS THE CLICKER 700 WEIGHS APPROXIMATELY 260 LBS. AND THE CLICKER 1500 WEIGHS APPROXIMATELY 560 LBS. AND IF EITHER WERE ALLOWED TO SHIFT UNEXPECTEDLY IT COULD CAUSE PERSONAL INJURY OR EQUIPMENT DAMAGE. READ THIS MANUAL AND AT ALL TIMES USE COMMON SENSE WHEN USING THIS MACHINE. BE SURE OTHERS WHO MAY OPERATE OR PERFORM MAINTENANCE HAVE ALSO READ THIS MANUAL AND ARE RESPONSIBLE AND SAFETY CONSCIOUS.

The Cutting bed is adjusted at the factory to allow the use of either .937" cutting dies or 1.25" cutting dies.

• If the blade does not penetrate through the material an adjustment may be necessary.

BOTTOM VIEW OF 7 TON

(Bottom View of model 700 shown)
Cutting Bed Adjustment Bolts (4)

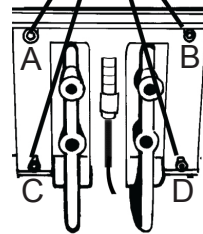

To adjust the cutting depth of the machine:

1. Disconnect the air supply to the Clicker.
2. Cycle the Clicker to exhaust any remaining pressurized air.
3. Read and adhere to the above Safety Precautions.
4. Locate the 4 cutting deck adjustment bolts on the bottom of the Clicker. (a, b, c, d - above)
5. Turn out Bolt (A) counterclockwise 1/4 turn.
(This will move the deck approximately 1/64" deeper into the cutting bed.)
6. Turn out Bolt (B) counterclockwise 1/4 turn.
7. Turn out Bolt (C) counterclockwise 1/4 turn.
8. Turn out Bolt (D) counterclockwise 1/4 turn.
9. Return Clicker to a secure position on a sturdy workbench.
10. Reconnect Clicker to air supply and run test cut to confirm that proper depth has been achieved. Repeat as necessary.

NOTE: IT MAY NOT BE NECESSARY TO ADJUST ALL (4) BOLTS. ADJUST ACCORDING TO WHAT SECTION OF YOUR PRESS IS NOT CUTTING.

IMPORTANT! AFTER MULTIPLE ADJUSTMENTS IT MAY BE NECESSARY TO APPLY RED LOCKTITE TO THE ADJUSTMENT BOLTS.

TROUBLE SHOOTING

- **Material is not completely cut.**

- Make certain that your machine does not have air leak.**

- Make sure your die's cutting edge has not become excessively dulled.

- Adjust cutting depth* as outlined in adjusting the cutting bed on page 6-7

- **Cutting bed cutting Surface has become severely worn after much use.**

It has developed uneven or severely worn spots causing some portions of die pattern to remain uncut.

- Replace cutting bed.

- **Cutting bed does not raise when Dual Palm Buttons are pressed.**

- Check to be sure air supply is hooked to Clicker and has adequate pressure.

Cutting Depth - When Dual Palm Button are simultaneously pushed, the Clicker is designed so that the bottom bed raises approximately 1" pressing the die cutting blade through the material to be cut approximately 1/32" - 1/16" into the cutting surface to insure a fine cut.

- **The machine seems to have an air leak.**

There are 2 places on your Cicker press to check for air leaks.

- Make sure your air is turned on and press the dual palm buttons, and locate the leak by sound. If there is a leak, it will be coming from either the control box or the under side of the press.

1. If the leak is coming from the control box you will want to follow these steps.

- 1). Remove control box cover

- 2). Check all fittings to make sure that they are airtight.

- 3). If you are able to locate the leak, you will need to replace the faulty fittings. **Ex.** The hose to the barb (male fitting) is not properly seated. If this is the case, remove hose and cut 1/2" back. Re connect hose and the clamp.

2. If the leak appears to be coming from the underside of the press, it is either coming from the bladder or the quick exhaust. Please contact Tippmann Industrial Products for further instruction on how to fix the leak.

- I have checked both the control box and the underside of the machine for leaks, but the leak appears to be coming from the compressor or the compressor hose. How should I proceed?

- If you have determined that you have an air leak coming from your compressor hose, please refer to your compressor manual or contact your compressor manufacturer.

Custom DIE SERVICE

Tippmann Industrial offers a complete custom die service. Tippmann Industrial will custom manufacture just about any die you can imagine. Quickly available and competitively priced, Tippmann is sure to satisfy, we guarantee it.

We stand behind our product and our on time delivery, because we realize that your success is counting on it. Delivery time depends on die complexity. Please specify due date. RUSH DELIVERY is available. In order to serve you, we can accept die drawings directly through our web site, or we can also accept faxes. If sending us a file via internet, Preferred file type is PDF. Please visit: tippmannclicker.com

When ordering via internet: www.tippmannclicker.com

- Please attach a line diagram or pattern to scale.
- It is very important that you send us the exact size and shape that you need.
- Please include dimensions on the drawing or diagram, so that we are sure the dimensions are identical to what you are looking for.
- After we receive your drawing, we will then email you a quote.

When ordering over fax:

If you are going to send us a drawing via fax, please call us first:

TOLL FREE: 866-286-8046, to go over any questions you may have before faxing the drawing to us. After discussing the order with us, you will then want to fax it to: **FAX: 260-441-8264**

- Please include line diagram to scale
- It is very important that you send us the exact size and shape that you need.
- Please include dimensions on the drawing or diagram, so that we are sure the dimensions are identical to what you are looking for.
- After we receive the fax, we will then call with a quote.

Note: Holes and slots can be placed in the die when we produce it, thus eliminating some of the additional working of the material after die cutting.

Note: Dies larger than the Clicker's cutting bed can be used with the Tippmann Clicker. To do this, place the die and material over hanging either end of the Clicker and make a single cut. You will then slide the overhanging* die and material into the Clicker bed and cut again.

Die Specs:

- 1 1/4" side face double bevel
- We also have 6 and 8 point dies available

Guidelines for price quoting:

- linear inches of die blade
- punches, and slot punches available
- Slit pricing is available

Prices subject to change.



WARRANTY AND REPAIR POLICY

Tippmann Industrial Products, Inc., is dedicated to providing you with the precision manufactured Tippmann Clicker die cutting machine and the quality support necessary for the utmost satisfaction in its use. In the event warranty or other non-warranty related repairs are required, we are here for you.

For assistance with warranty and repair call **1 (260) 441-9603**.

WARRANTY STATEMENT

Tippmann Industrial Products, Inc. warrants that this product is found free from defects in materials and workmanship for a period of 1 year from the original date of purchase by the initial owner/ purchaser. (freight is customers responsibility) On claims submitted as outlined in "WARRANTY OR REPAIR PROCEDURE" Tippmann Industrial Products, Inc. will repair or replace, without charge, any parts that have failed through defect in material or workmanship.

TIPPMANN

INDUSTRIAL PRODUCTS, INC.

WARRANTY OR REPAIR PROCEDURE

For warranty and non-warranty repair, after calling the above warranty and repair, ship or deliver your Tippmann Clicker or specific parts to Tippmann Industrial Products, Inc. postage or delivery charges prepaid, a brief statement regarding the requested repair, your name, address and telephone number where you can be reached during normal business hours, if possible.

SHIP TO:

**TIPPMANN INDUSTRIAL PRODUCTS, INC.
3518 Adams Center Road
Fort Wayne, IN 46806**

TIPPMANN CLICKER MODEL 1500

Schematic

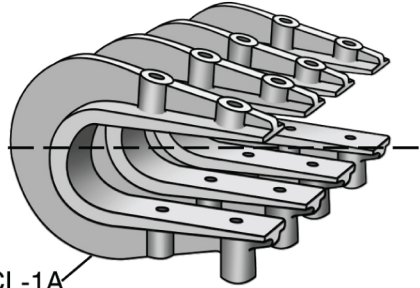
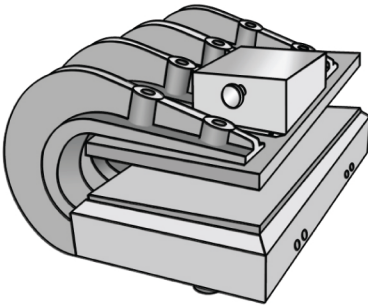

Control Box sold complete as one replacement part - CB-15

CL-3 Control Box (Housing Only)

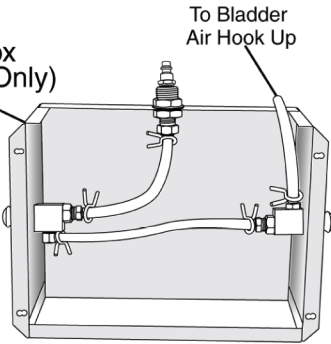

To Bladder Air Hook Up

CL-1A C-Castings (4)
RG-16 Quick Connect

To Bladder Air Hook Up

CB-03 1/4 NPT x 1/4" Barb

CB-05 Bulkhead

CB-07 8-32 x 3/16" Set screw

CB-07 8-32 x 3/16" Set screw

CL7-54 Button

CB-01 Valve

CB-04 1/8 NPT x 1/4" Barb Elbow

Control Box Insides

CB-06 Hose Clamps (5)

CL-60 1/4" I.D. Tubing (2)

CB-02 1/8 NPT x 1/4" Barb (3)

CB-01 Valve

CL7-54 Button

- CL100-9
1/2-13 X 1" SHCS (8)
- SM-100-19 10-32 x 1/4"
Button Head Cap Screw (4)

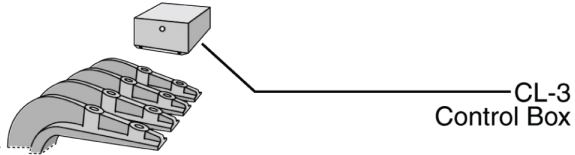

- CL-3
Control Box

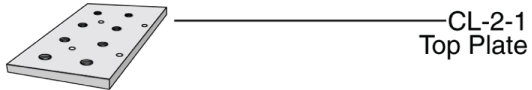

- CL-2-1
Top Plate

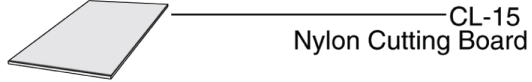

- CL-15
Nylon Cutting Board

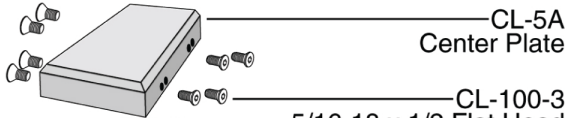

- CL-5A
Center Plate

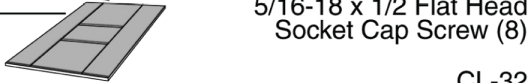

- CL-4
Bladder

- CL-100-3
5/16-18 x 1/2 Flat Head
Socket Cap Screw (8)

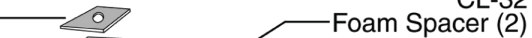

- CL-32
Foam Spacer (2)

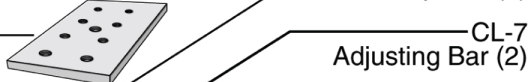

- CLK-33-1
Bladder Tape
- CL-2-1A
Bottom Plate

- CL-7
Adjusting Bar (2)

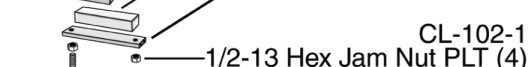

- CL-102-1
1/2-13 Hex Jam Nut PLT (4)

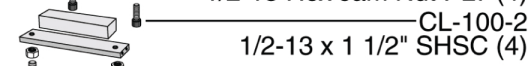

- CL-100-2
1/2-13 x 1 1/2" SHSC (4)



- CL-60
1/4" I.D.
Tubing

- CL-16 1/4" Pipe Close Nipple
- CL-21 Quick Exhaust 1/4"

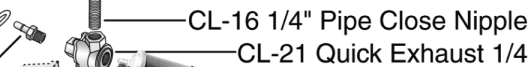

- CB-06
Hose Clamp

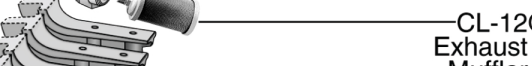

- CL-62
1/4" x 1/4"
Barb Fitting

- CL-12Q
Exhaust
Muffer



- CL-100-2
1/2-13 x 1 1/2
SHSC (8)

TIPPMANN CLICKER MODEL 700

Schematic

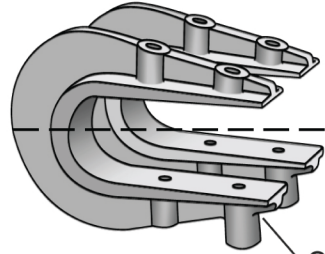
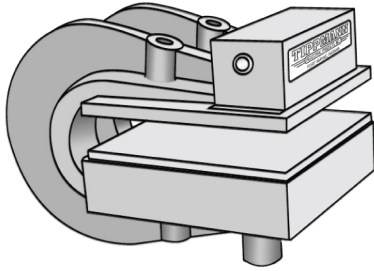

Control Box
sold complete
as one replacement
part - CB-7

CL7-3
Control
Box
(Housing
Only)

To Bladder
Air Hook Up

RG-16
Quick
Connect

To Bladder
Air Hook Up

CB-07
8-32 x 3/16"
Set screw

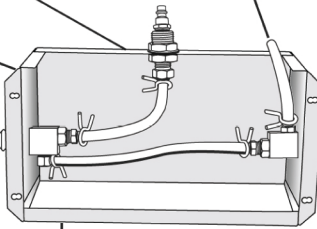

CB-03
1/4 NPT
x 1/4"
Barb

CB-05
Bulkhead

Control Box
Insides

CB-07
8-32 x 3/16"
Set screw

CL7-54
Button

CB-01
Valve

CB-04
1/8 NPT
x 1/4"
Barb Elbow

CB-06
Hose
Clamps
(5)

CL-60
1/4" I.D.
Tubing
(2)

CL7-54
Button

CB-01
Valve

CB-02
1/8 NPT x 1/4"
Barb (3)

SM-100-19
10-32 x 1/4"
Button Head
Cap Screw (4)

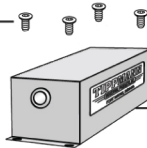

CL7-3
Control Box

CL100-9
1/2-13 x 1 SHCS (4)

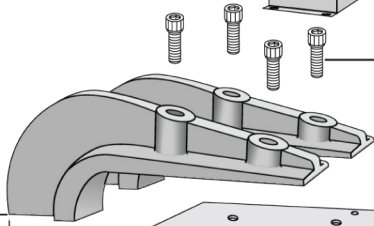

CL7-2TM
Top Plate

CL7-15
Cutting Board

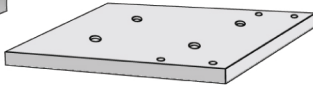

CL7-5MM
Middle Plate

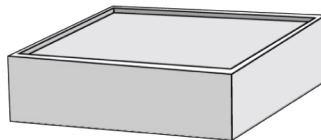

CL7-4
Bladder

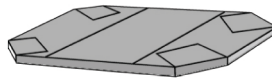

CLK-33-1
Bladder Tape



CL7-2BM
Bottom Plate

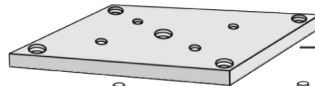

CL-100-7
1/2-13 x 2 1/2"
SHCS (4)

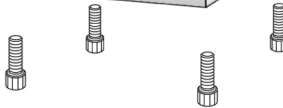

CL-60
1/4 I.D.
Tubing



CB-06
Hose
Clamp



CL-62
1/4" x 1/4"
Barb Fitting



CL-16
1/4" Close
Nipple



CL-21
Quick
Exhaust
1/4"



CL-12Q
Exhaust
Muffler



CL-68
Spacer (2)

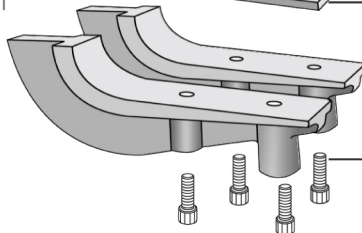

CL-100-2
1/2-13 x 1 1/2"
SHCS (4)

CL-SLIDE

SLIDE DECK

The slide deck allows you to slide the entire cutting deck in and out of the machine in order to load the material and die. This will allow you to view the exact location when loading your die.

Call for Price

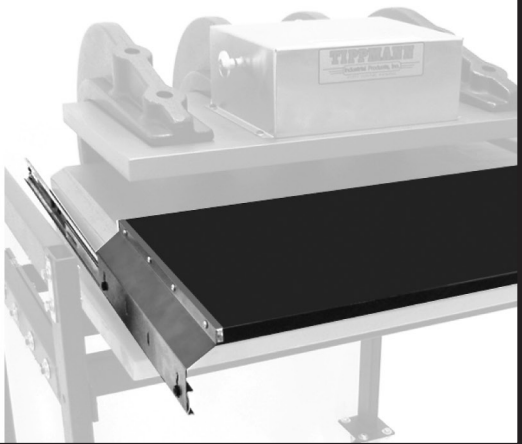

CL-2H

2 HAND - NO TIE DOWN - DUAL PALM CONTROLS

If your company mandates **2 HAND NO TIE DOWN compliance**, we can handle it. Our dual palm controls will bring your Clicker up to standard. The dual palm controls will not let the machine operate unless both the left and right buttons are held simultaneously.

Call for Price



CLK-100 (CALL TO CHECK AVAILABILITY)

CASTERS

You can turn your Tippmann Clicker Press into a mobile work station by adding easy glide casters to your Clicker 700 stand. (set of 4)

Note: casters come standard on the Clicker 1500 stand.

Call for Price



CUSTOM DIE BLADES

We offer custom die services



- 1.) Send us a line diagram or pattern
- 2.) We will call you with a quote
- 3.) Upon final approval, we will ship your completed die to you.

Air Accumulator System

CCL-33 1500 Clicker
CCL-33-1 700 Clicker



Call for Price

CL-STAND-CAST



**Heavy Duty
Table for Clicker
1500 Press**

Call for Price

Allows you to slide material in and out of the Clicker with ease.
(casters included)

CL7-STAND



**Heavy Duty Table
for Clicker 700 Press**

Call for Pricing

Allows you to slide material in and out of the Clicker with ease.



MISCELLANEOUS

DESCRIPTION..... (NOT PICTURED).....	PART#...	PRICE
Clicker cutting bed tape.....	CL- TAPE...	\$Call
7 Ton Clicker Replacement Cutting Board (thin) 1/2".....	CL7-15.....	\$Call
15 Ton Clicker Replacement Cutting Board (thin) 1/2".....	CL-15.....	\$Call
7 Ton Clicker Replacement Cutting Board (thick) .813".....	CL7-14.....	\$Call
15 Ton Clicker Replacement Cutting Board (thick) .813".....	CL-14.....	\$Call

TIPPMANN

INDUSTRIAL PRODUCTS, INC.

3518 ADAMS CENTER RD.

FORT WAYNE IN, 46806

TOLL FREE: 866-286-8046

www.tippmannclicker.com