



**CN2053R-1A**

**CN2053R-2A**

**CN2073R**

**INSTRUCTION MANUAL  
AND PARTS BOOK**

# CONTENTS

1. Application.....	1
2. Secure operation .....	1
3. Caution before operation.....	1
4. Lubrication.....	1
5. Selection of needle and thread .....	2
6. Inserting the needle .....	3
7. Replacing the bobbin case .....	3
8. Threading the bobbin .....	4
9. The installation of bobbin .....	6
10. Threading the machine.....	7
11. Adjusting stitch length.....	7
12. Adjusting presser foot pressure .....	8
13. Adjusting needle thread tension .....	8
14. Regulate the length and tension of the take-up spring.....	9
15. Adjusting bobbin thread tension .....	9
16. Adjusting needle position.....	10
17. Adjusting the stitch width .....	11
18. Locking unit for linear stitching .....	11
19. Assembling the belt cover.....	12
20. Mount knee lifter .....	13
21. Modes of sewing.....	14
22. Maintenance of the machine .....	18
23. Main specification .....	18

## 1. APPLICATION

This series of zigzag sewing machine is used to sew straight, zigzag and embroidery stitches on thin, medium and thick material for garments, bed articles, shoes, towels and wall carpet.

## 2. SECURE OPERATION

- 1) The operator should be retrained and understand this manual very well before operating.
- 2) All safety equipment should be fixed very well while running the machine.
- 3) Turn off the power when changing sewing accessories (like the needle, presser foot, needle plate, feed dog and bobbin case).
- 4) Maintenance and adjustment of the machine should be done by a professional technician.
- 5) The electrical requirements should be managed by an electrician or professional technician.

## 3. CAUTION BEFORE OPERATION

To avoid damaging the machine, do the following:

- 1) Clean the machine thoroughly and add enough oil before first usage.
- 2) Check the normalcy of voltage before first usage.
- 3) The upper wheel should rotate in the direction facing the operator.

## 4. LUBRICATION (Fig.1,2)

- 1) Rotate the upper wheel to the oil hole; add one or two drops of oil.
- 2) Add one or two drops of oil wherever an arrow is marked in the diagram.
- 3) Add a little oil to the sign "B" on the gear.
- 4) Add enough oil at the sign "A" on the upper cover.
- 5) The suggested lubrication oil is lily white sewing machine oil or HT-T machinery oil.

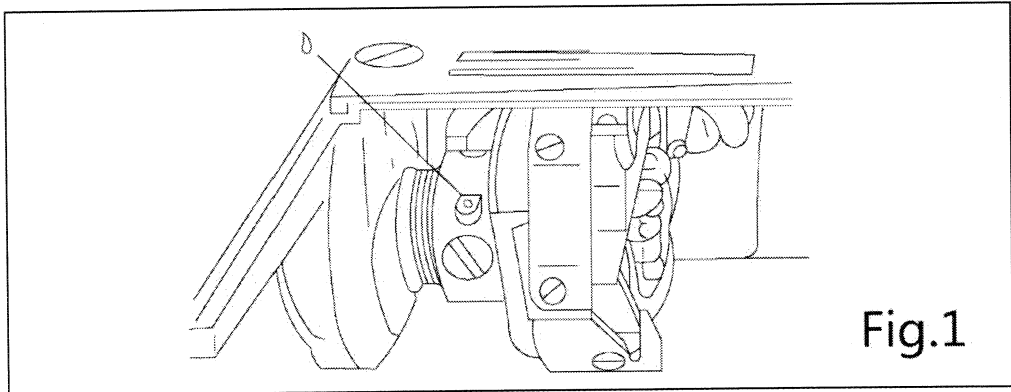

Fig.1

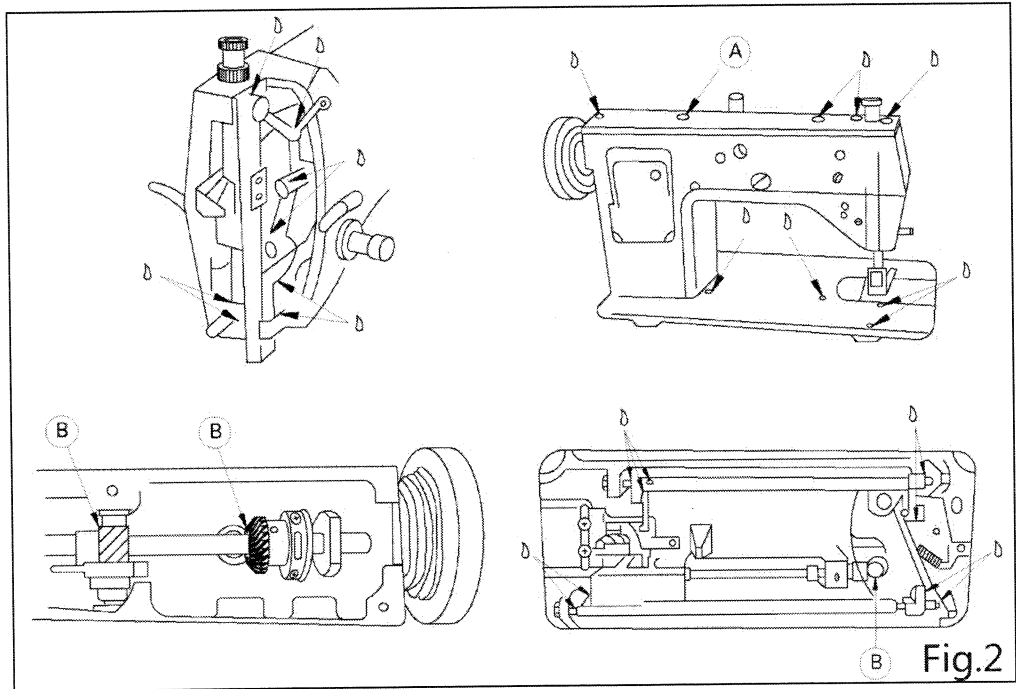

Fig.2

## 5. SELECTION OF NEEDLE AND THREAD

Select the appropriate thread and needle according to the different sewing material as follows:

Applicable kind of material	thin	Medium heavy material	Heavy material
Max size of thread	120	60	30
Needle size (1/100mm)	#10	#12---#16 (80-100)	#18---#19 (110-120)
Needle type	1910-05(135x9)		
Other equal suitable size thread usable			

## 6. INSERTING THE NEEDLE(Fig.3)

Turn the hand wheel and raise the needle bar to the highest position, then loosen the needle tightening screw 1. Insert the needle in the needle bar and push it up as far as it will go.

Make sure its long groove faces toward the front. Tighten needle set screw 1 securely.

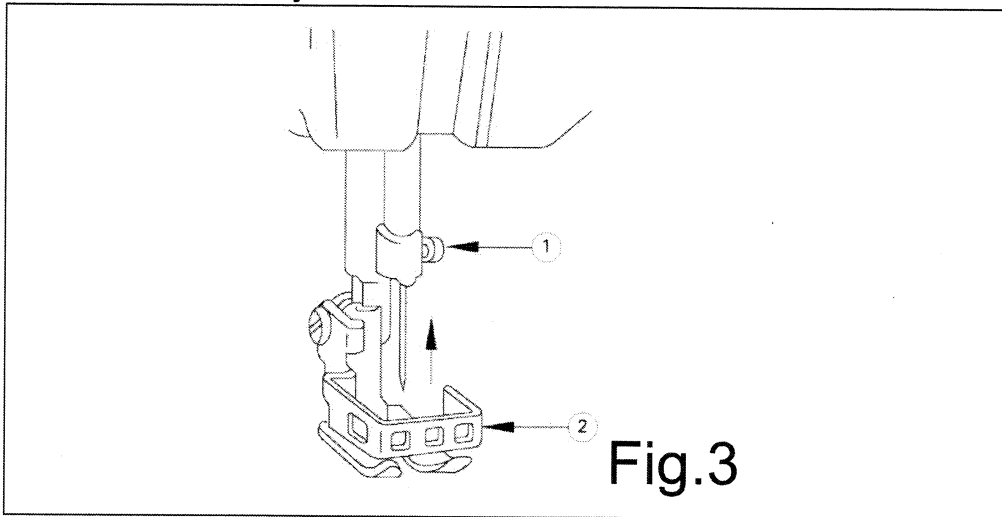

## 7. REPLACING THE BOBBIN CASE(Fig.4,5)

Raise latch 1. Then pull out the bobbin case 2.

To reinsert the bobbin case, open latch 1 and place the case on shaft 2. While the latch is open, fit case hook 3 into location 4. Then press the case inside and close the latch.

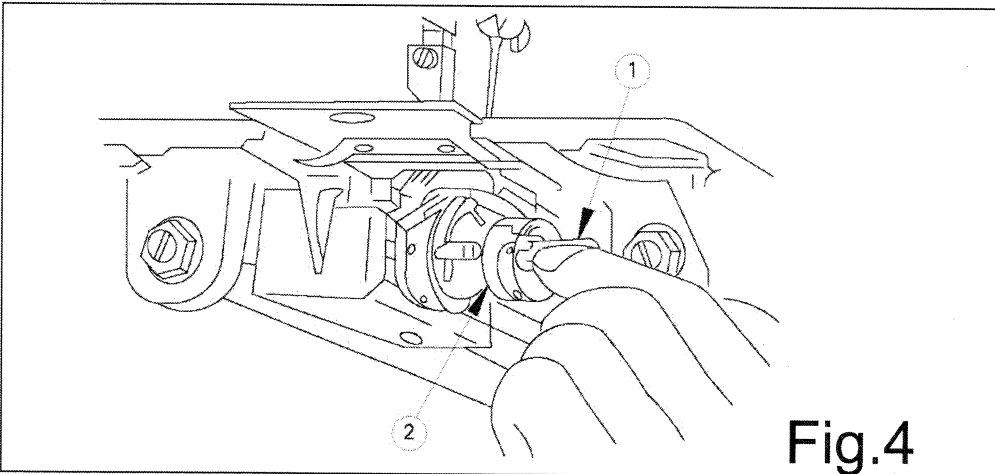

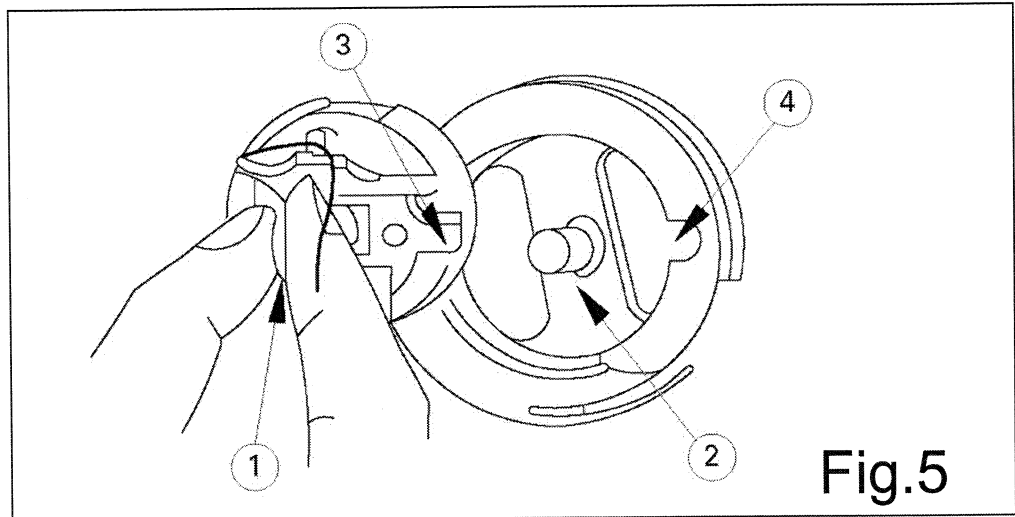

## 8. THREADING THE BOBBIN

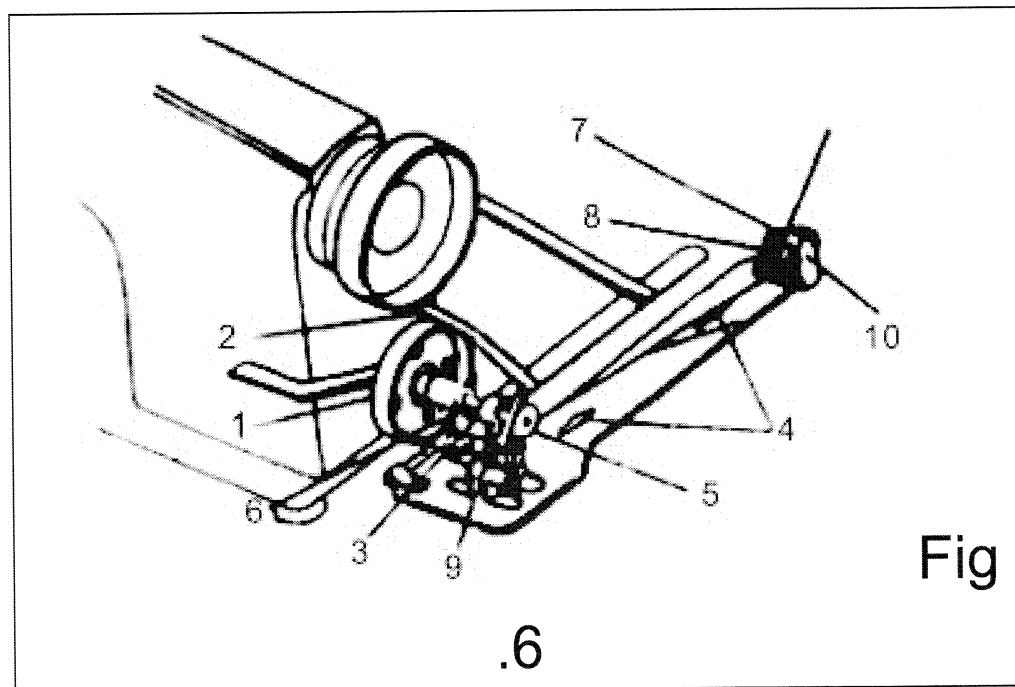

(1) CN2053R-1A/CN2053R-2A

- a) Put the bobbin onto the winding shaft. Push the thread adjustment plate 9 and wind the thread.
- b) Adjust the screw 8 to change the tension of the winding thread.
- c) Move the pre-tension 10 to adjust the thread evenness of

the bobbin..

(2) CN2053R-1A/CN2053R-2A

- a) Stop the motion of needle by loosening stop-motion screw (1). Hold hand wheel with left hand and turn stop-motion screw toward you with right hand.
- b) Place bobbin on bobbin winder spindle (3), pushing it on as far as it will go.
- c) Pre-tension(1)  
+.....More tension.  
-.....Less tension

3) Push latch (2) in the direction indicated by arrow (A), then start the machine.

Bobbin winder spindle (3) rotates in the direction indicated by arrow (B).

To adjust the amount of thread on bobbin, loosen screw (4) on latch (2) and swing the latch (2) away from you or toward you.

Swing latch (2) away from you.

For less thread on bobbin, swing latch (2) toward you, if thread winds unevenly on bobbin, loosen screw(5) and move pre-tension (6) up or down, as required, and tighten screw(5).

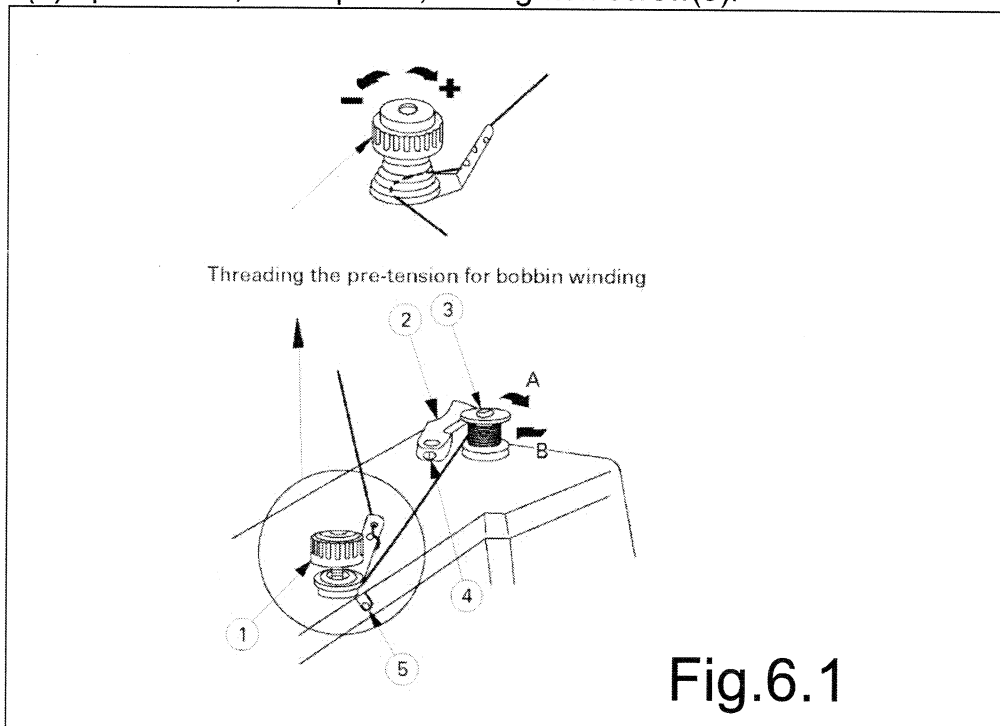

## 9. THE INSTALLATION OF THE BOBBIN(Fig.7,8,9,10)

1) Put the bobbin into bobbin case. Pull thread into notch (1) and draw it under tension spring (2).(Fig.7)

2) Pull the thread out from slot 2 on end of spring 1.(Fig.9)

3) Pass it through the bobbin case thread guide (1) and allow about 60mm of thread out of the bobbin.(Fig.10)

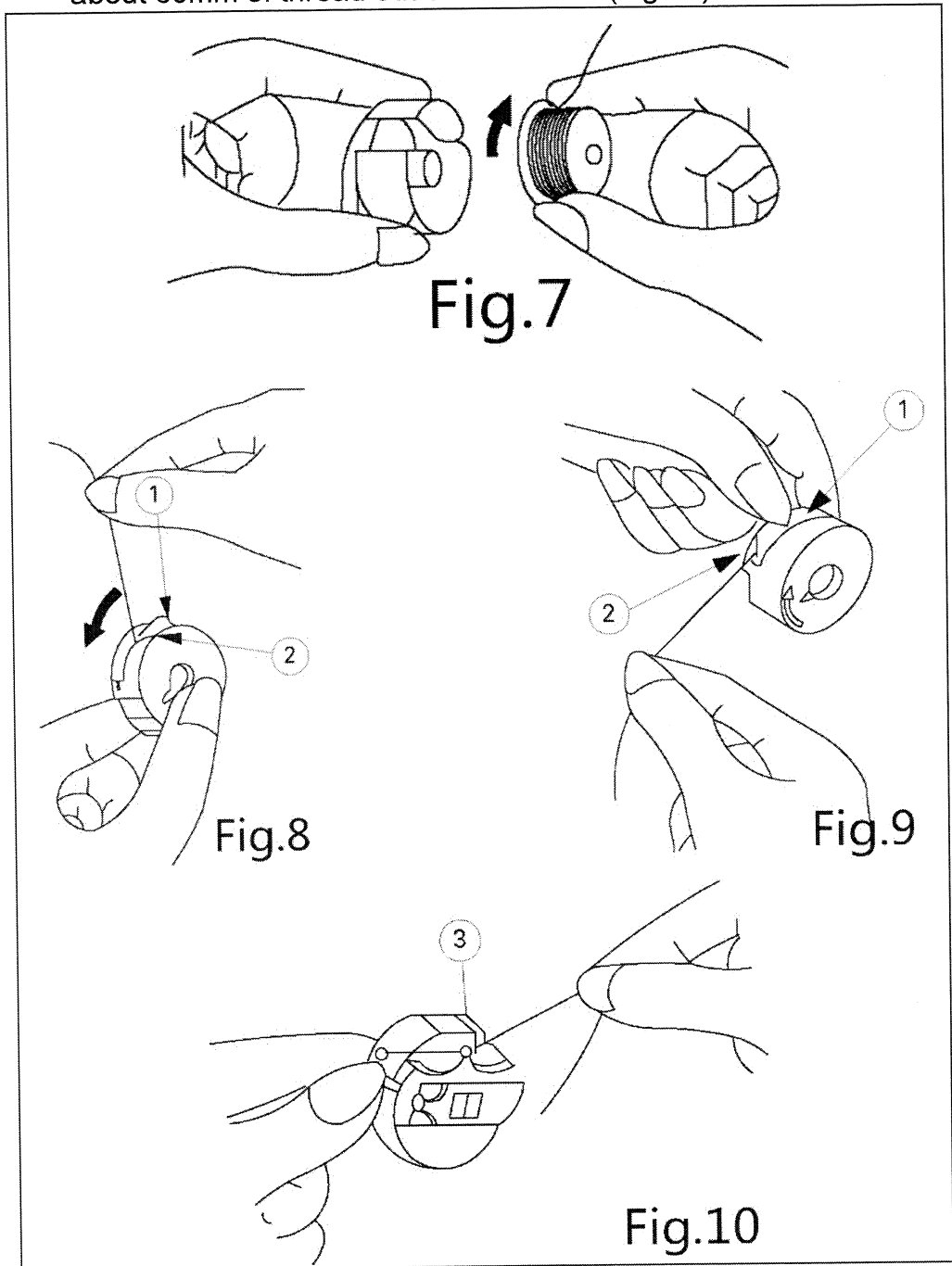



## 10. THREADING THE MACHINE(Fig.11,12,13,14)

- 1) Raise needle bar to the highest position, then pull the thread out and through A, B, C, D, E and F.
- 2) As shown in figure 14, thread from forward to back.
- 3) Pull about 100mm of thread out.

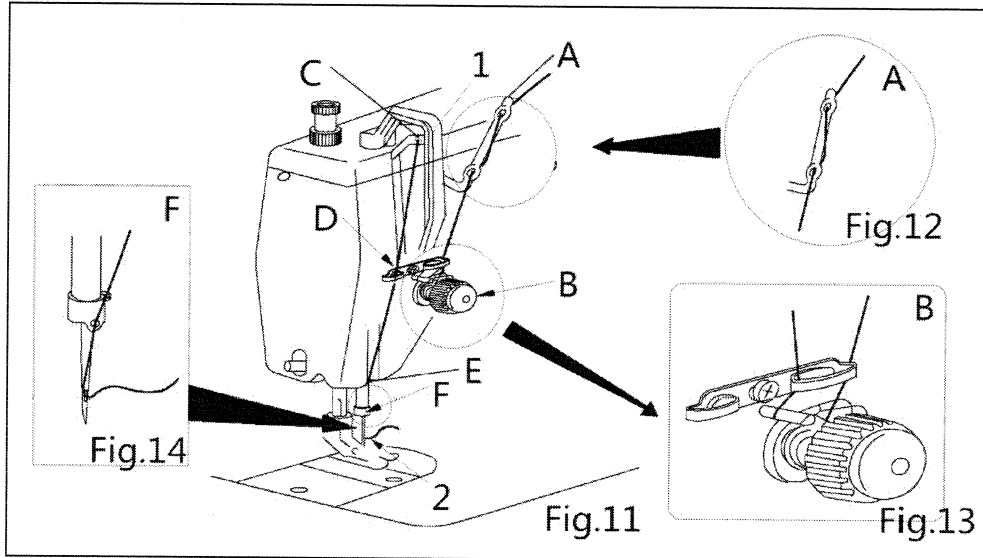

## 11. ADJUSTING STITCH LENGTH(Fig.15)

Regulating the stitch length

To regulate the stitch length, turn feed regulating dial 1 left or right as required,

+.....to lengthen

-..... to shorten

Changing the reverse feed

Push lever 2 down for reverse feed and release for forward feed.

To regulate the reverse stitch length, turn thumb screw 3 left or right as required.

+..... to lengthen

-..... to shorten

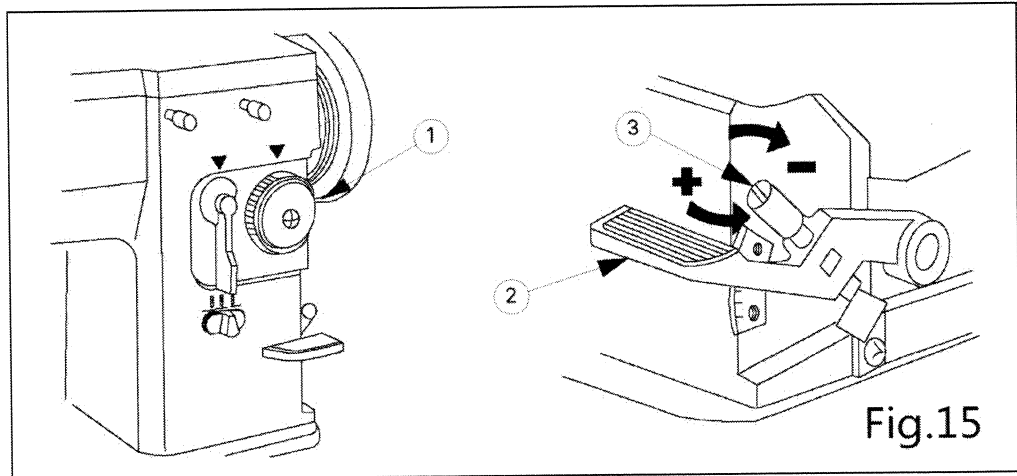

Fig.15

### 12. ADJUSTING PRESSER FOOT PRESSURE(Fig.16)

To regulate the presser foot pressure, turn pressure regulating screw 1 left to increase or right to reduce pressure.

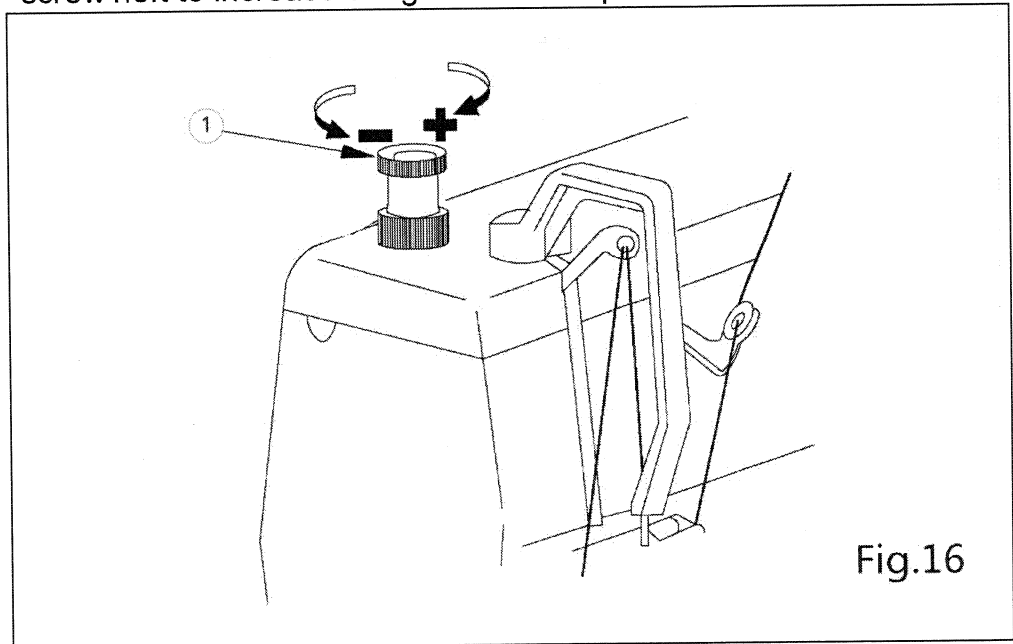

Fig.16

### 13. ADJUSTING NEEDLE THREAD TENSION(Fig.17)

Regulate the needle thread tension with tension regulating knob 1 by turning it left to strengthen or right to reduce pressure.

+..... more tension

-..... less tension

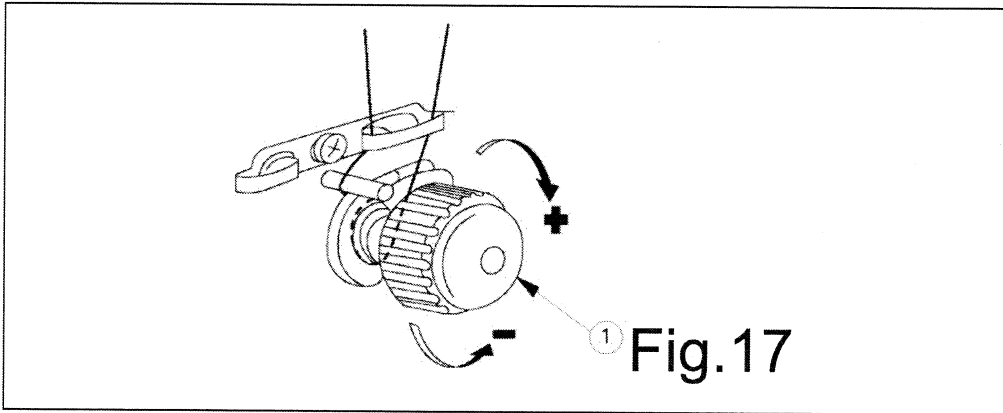

#### 14. REGULATING THE LENGTH AND TENSION OF THE TAKE-UP SPRING(Fig.18)

- 1) Regulate the tension of take-up spring by using a screw driver in the slot to regulate take-up spring tension by turning stud (1) as required.  
 +..... more tension  
 -..... less tension
- 2) Regulate the length of take-up spring  
 To adjust the amount of take-up spring movement, loosen screw 2 and set the take-up spring height by turning the entire tension assembly 3 left or right, then securely tighten screw 2.

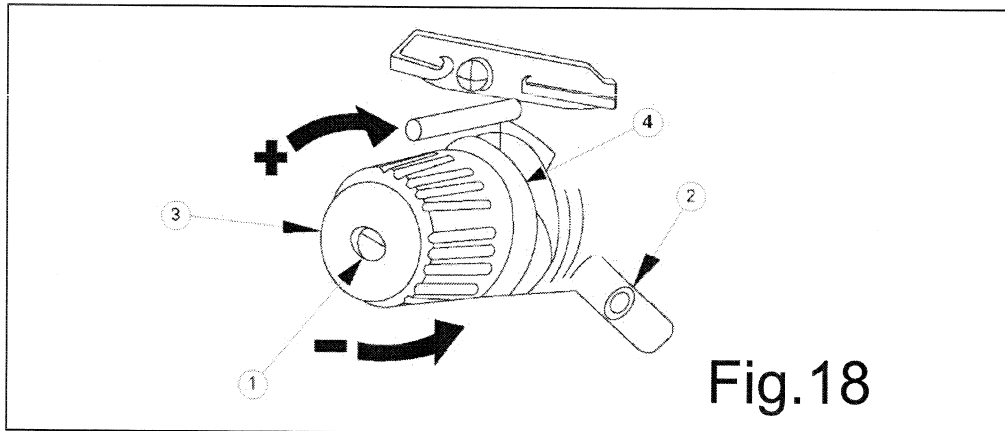

#### 15. ADJUSTING BOBBIN THREAD TENSION(Fig.19)

Regulate bobbin thread tension regulating screw 1.  
 +..... more tension

-..... less tension

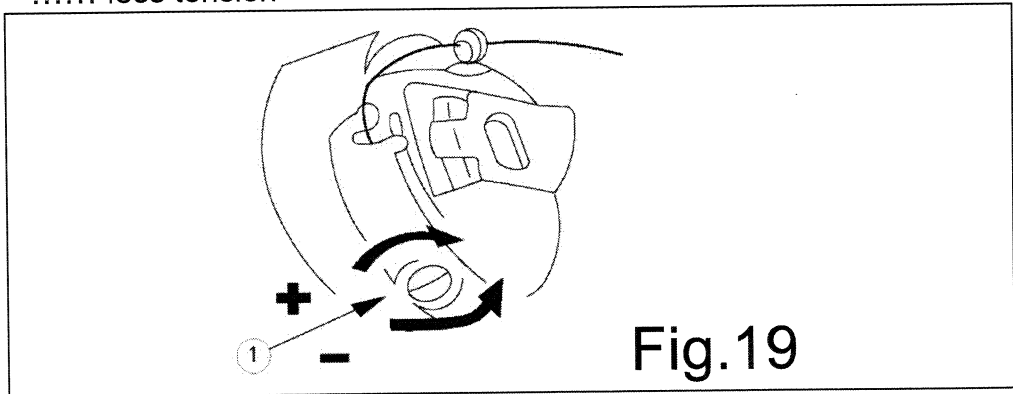

Fig.19

## 16. ADJUSTING NEEDLE POSITION(Fig.20)

(CN2053R-1A)

Left, center and right needle position settings are available for placement of both straight and zigzag stitching. (Fig.20)

To position, push lever in and move to desired setting.

Do not make any needle position adjustment while the needle is in the fabric.

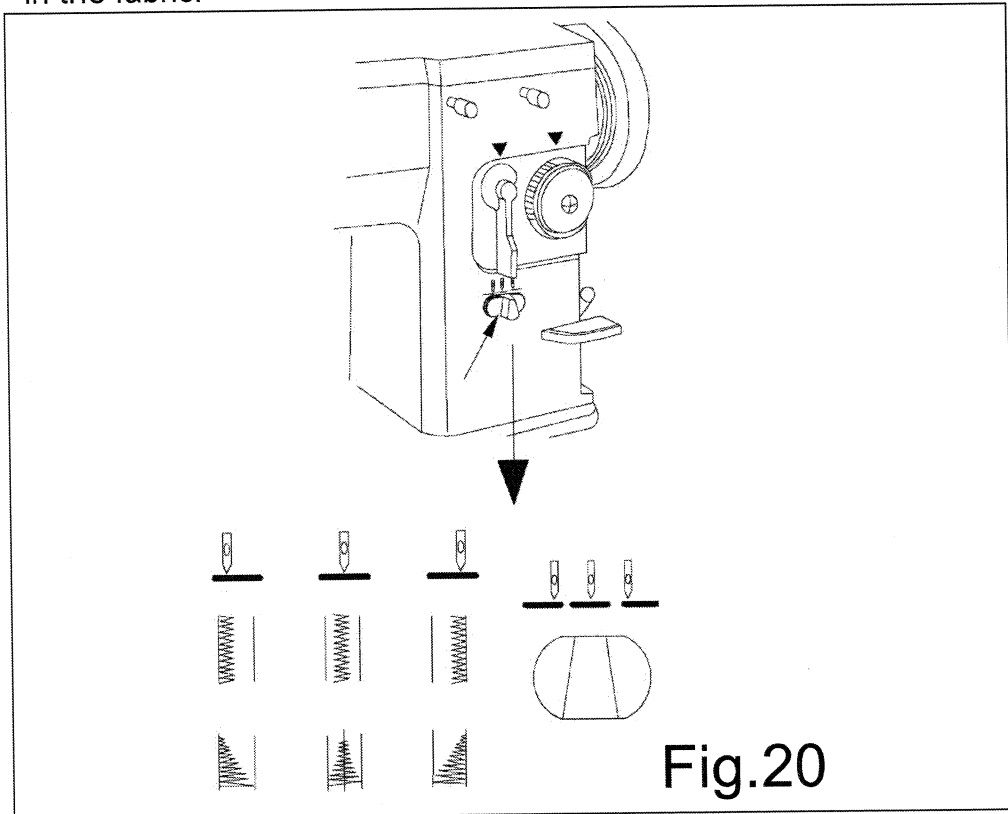

Fig.20

## 17. ADJUSTING THE STITCH WIDTH(Fig.21)

If one fixed value between the min-max of curvilinear stitch is needed, the adjustment can be made as follows:

- 1) Release the horizontal needle set screw 2;
- 2) Turn the spanner 3 to opposition (i.e. A position);
- 3) Lock the set screw 2;
- 4) Release the needle set screw 1;
- 5) Turn left the spanner 3 to B position;
- 6) Then lock the set screw 1.

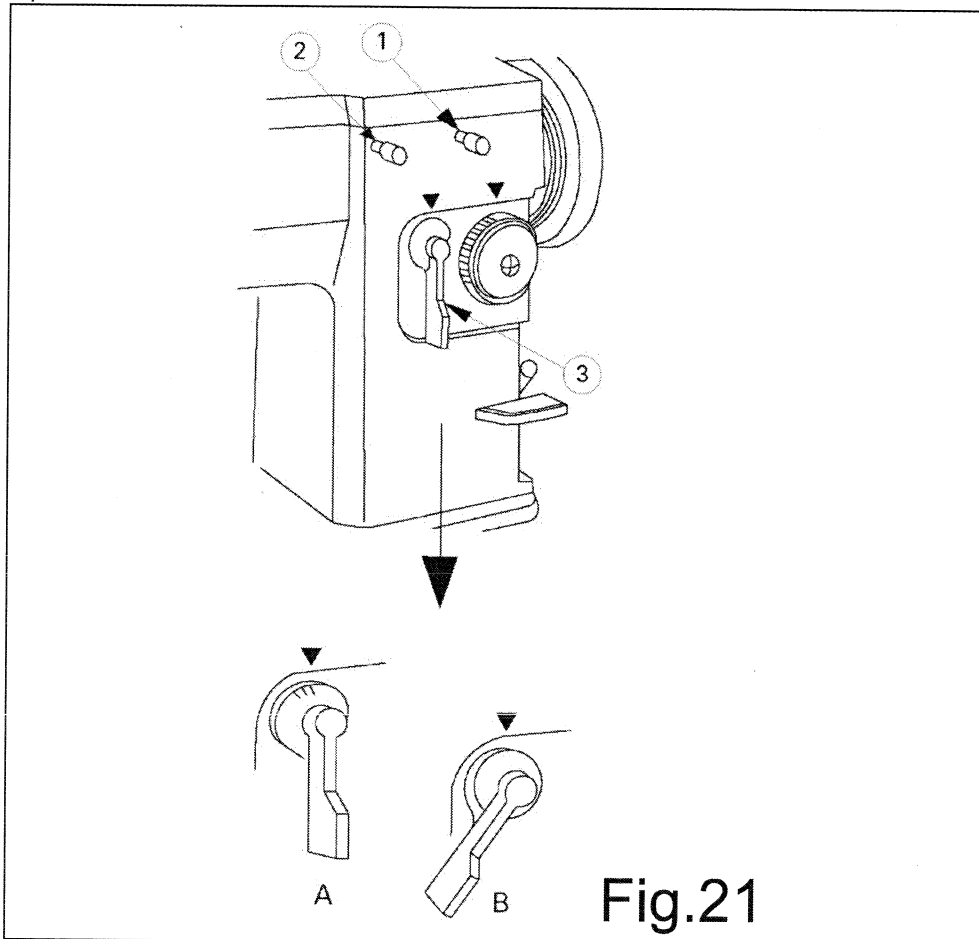
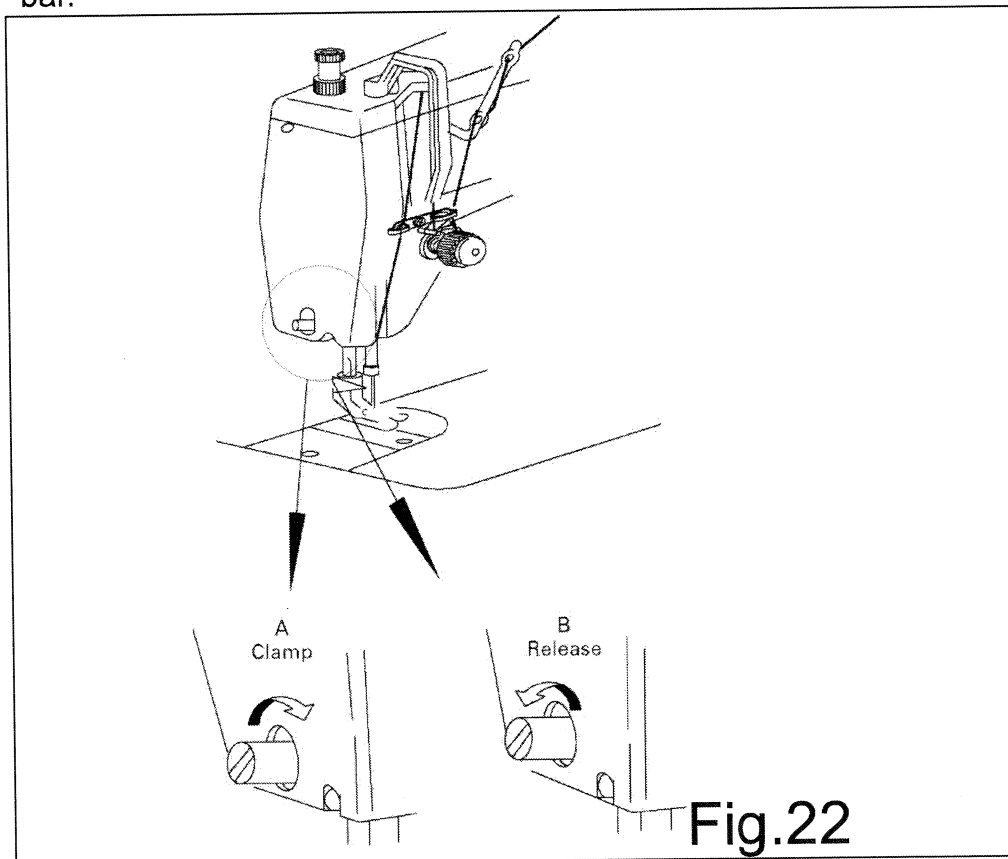

Fig.21

## 18. LOCKING UNIT FOR LINEAR STITCHING(Fig.22)

When linear stitch, turn the linear to "A" direction and locking eccentric sleeve clockwise and secure the needle-bar swaying rack. When the curvilinear stitching made, the eccentric sleeve should be turned counter-clockwise to "B" direction and locked securely onto

the machine housing, the release the swaying rack of the needle bar.



### 19. ASSEMBLING THE BELT COVER (Fig.23,24)

On the table: while the V type belt cover is line with belt cover, tighten the screw.

Under the table: after the assembling the belt cover the wheel and belt should rotate freely.

Remarks: Fig 23 is suitable for CN2053R-2A.

Fig 24 is suitable for CN2053R-1A.

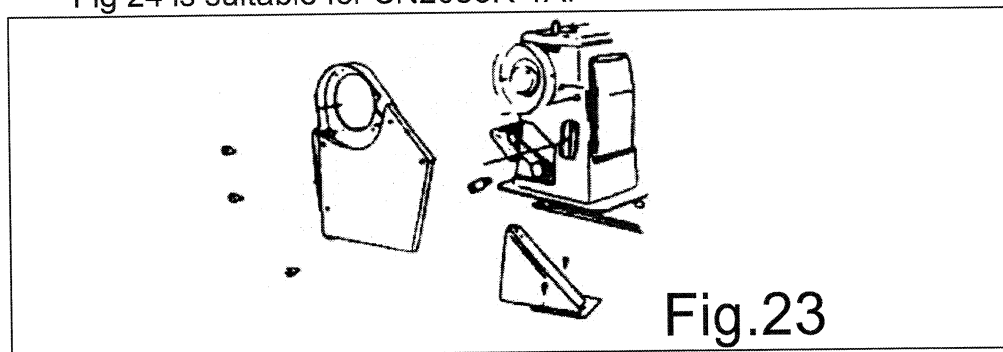

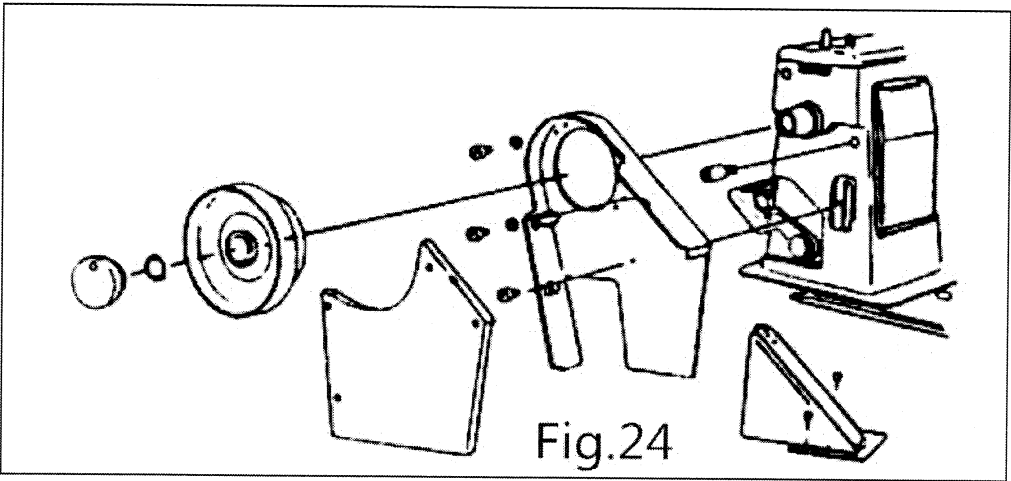

20. MOUNT KNEE LIFTER(Fig.25,26)

(1) CN2053R-2A

1) To assure the convenience of operation, adjust the knee lifter knee plate.

2) In the position of NO.2, while the NO. 2 control the NO.3; knee can control the sway of needle.

While the No.2 controls the NO.4, knee can control the lift of press foot.

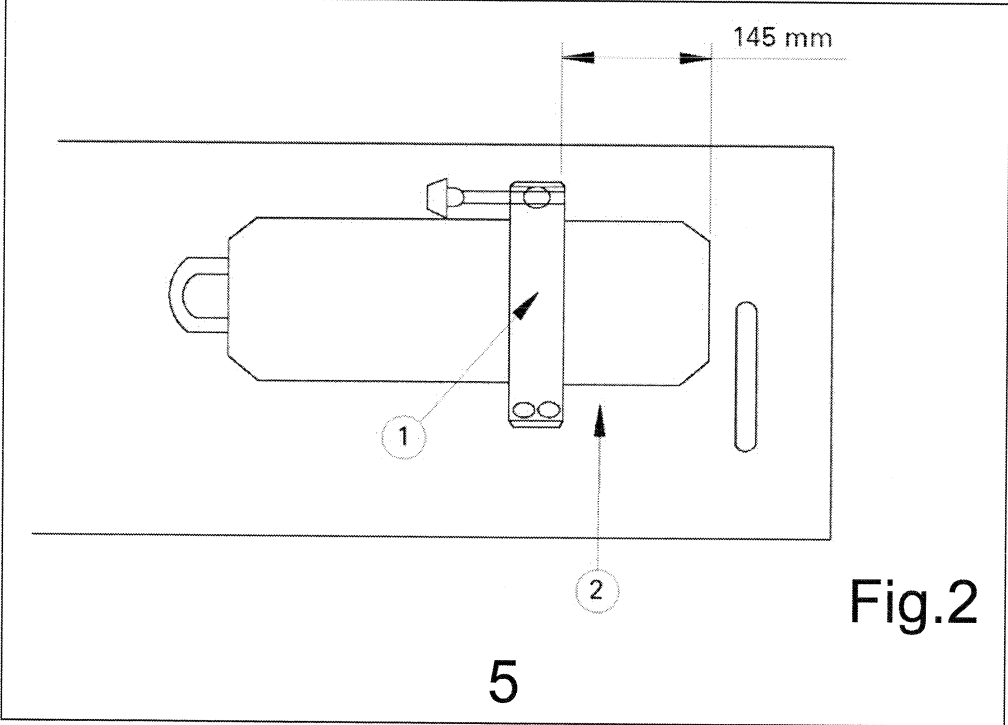

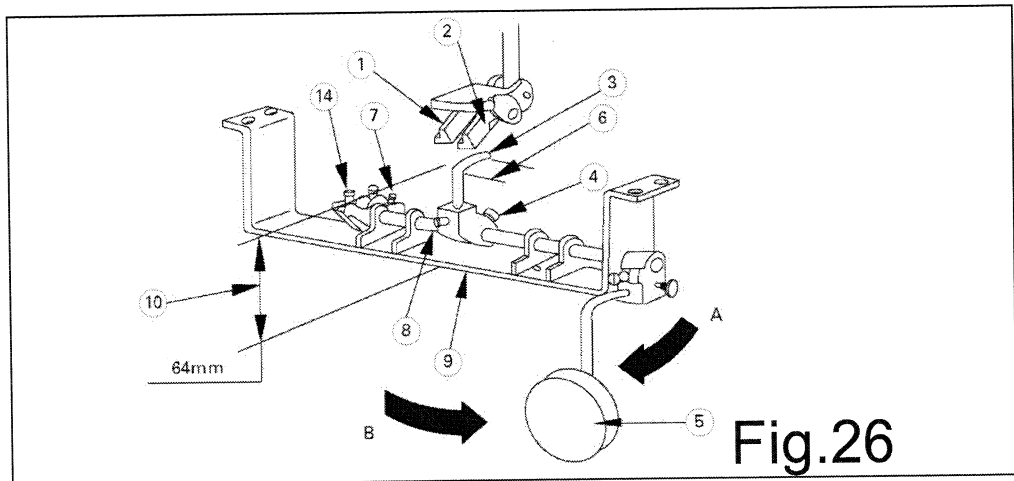

### (3) CN2053R-1A

- 1) Fix the knee lifter stand to the underside of the table 145mm away from the table channel.
- 2) While turn to figure 16 shows, knee controls the presser to lift or down.
- 3) While turn to figure 27 shows, knee control the stitch width.

## 21. MODES OF SEWING (CN2053R-1A)

### 1. Straight sewing

When straight stitching, using the straight stitch presser foot, needle and feed dog is better than using multi-function ones.(Fig.27)

The horizontal width should be adjusted to O position. The linear locking unit with swaying rack of locking needle shaft can be used in combination with swaying rack of locking needle shaft can be used in combination with special presser foot, needle plate and material feeding tooth.

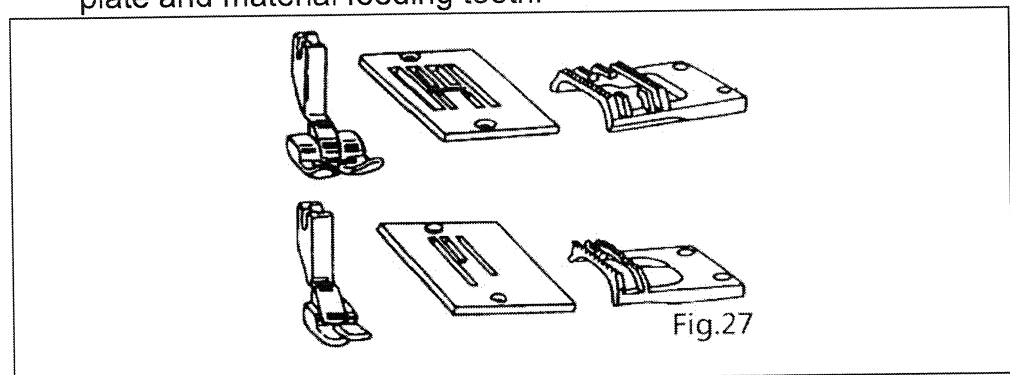



## 2. Embroidery

Preparation before embroidery

- 1) It should be noted that any free regulation can be made at the horizontal needle distance between min-max, set the vertical needle distance to 0 position and will; adjust the knee-control parts to make-the component control the movement of the sway of needle.(Fig.26)
- 2) Discharge the presser foot and needle plate and feeding dog and install the embroidering plate.
- 3) Hold firmly the end of the surface stitches with your left hand; turn out from the holes of the needle plate.
- 4) Make sure to stretch the material tightly between the internal and external embroidering frames. Otherwise, the machine will skip or break stitches or the material will get creased.(Fig.28)

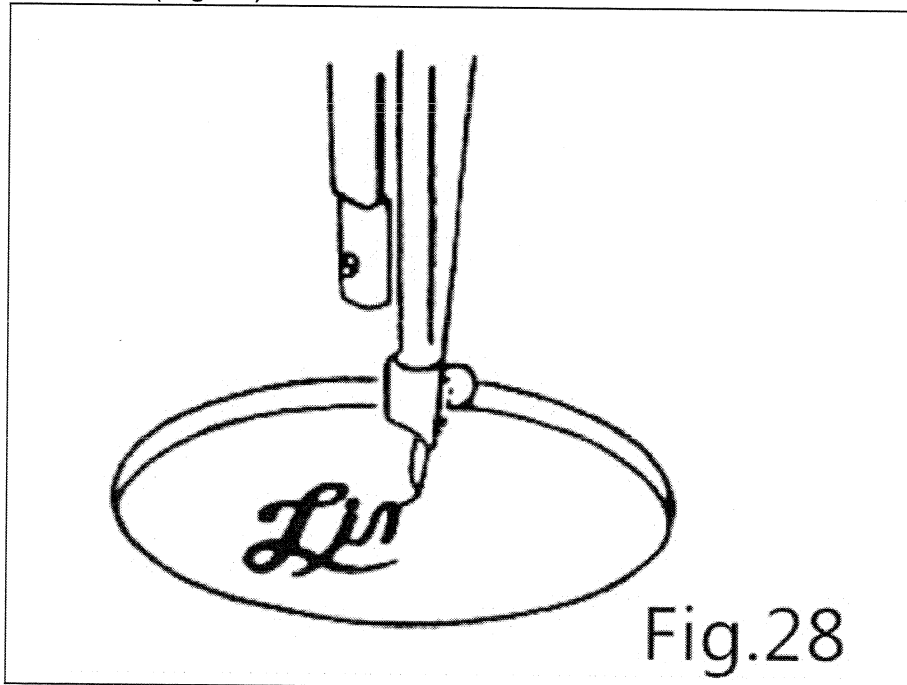

## 3. ZIPPER SEWING

In this mode, it is preferable to make use of the zippered presser foot (see Fig.31). In order to make the stitches more accessible to the projection stitches, release the screw B, regulate the presser foot and the needle to the presser foot and set the needle to left and right grooves A of the presser foot. The

mode is expected to be suitable for the following sewing.(Fig.29)

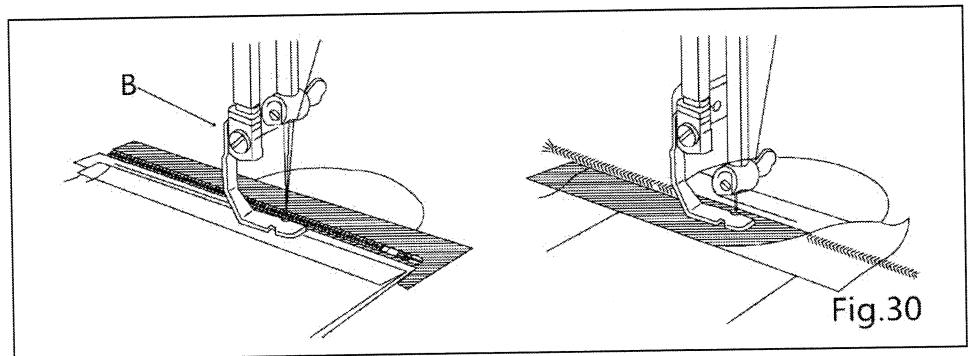
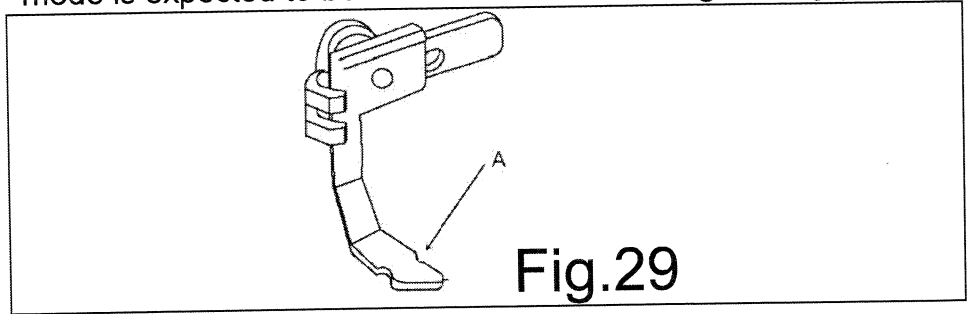

#### 4. HEM-WRAPPING MODE

In this mode, the hem-wrapping presser foot should be used (Fig.31)

Remove the multi-functional presser foot and replace it with the hem-wrapping one. This is also a mode of straight sewing so the needle set should be set to the central position. (Fig.32)

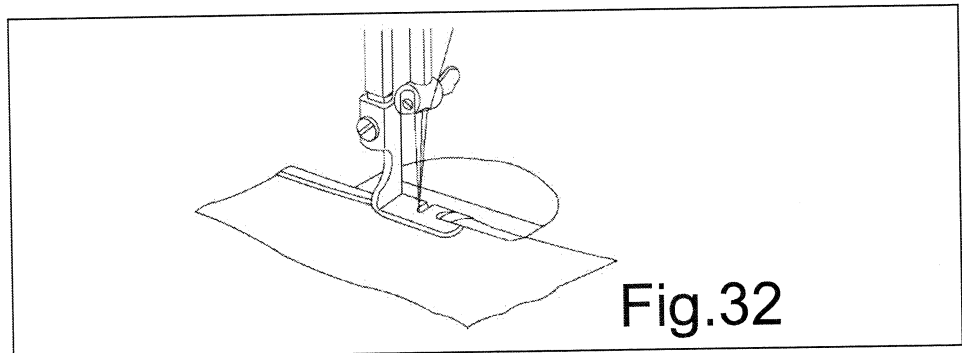
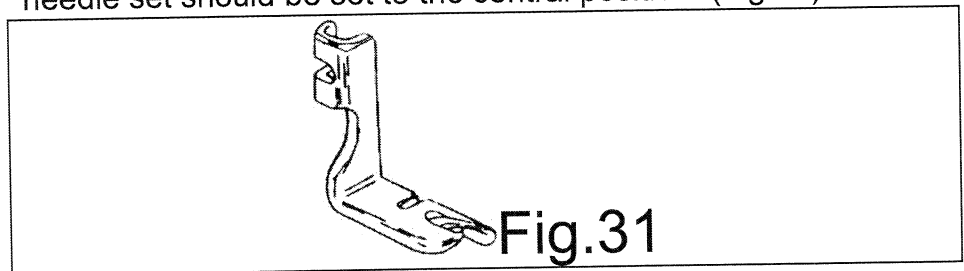

## 5. STEM-WRAPPING MODE

In the stem-wrapping mode, the special stem-wrapping presser foot, needle plate and feed dog should be used (Fig.33). The needle should be set to the central position and the horizontal needle distance set to 3mm. Then run the rougher thread through the small groove A on the stem-wrapping presser foot so that the sewing of this mode will be smooth.

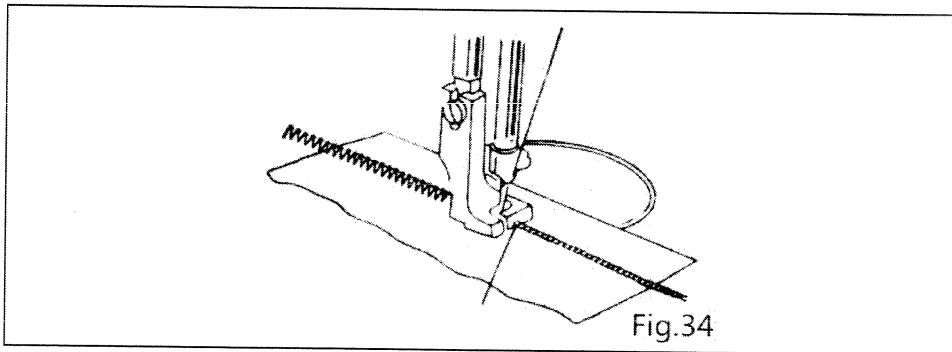
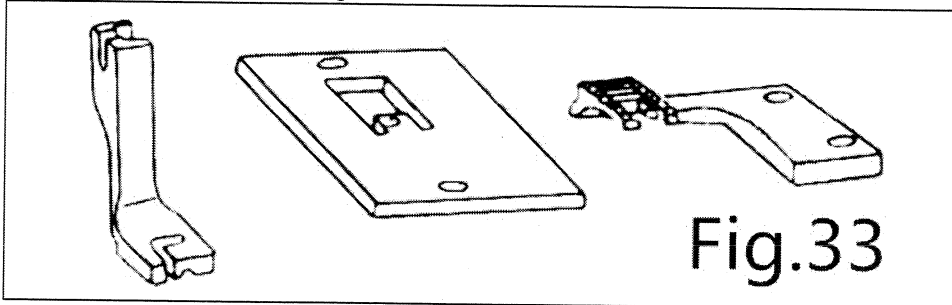

## 6. DECORATION SEWING(Fig.35)

If the left, central and right needle positions can be freely changeable and the horizontal needle distance skillfully controlled, the patterns of the decoration sewing will be well achieved.

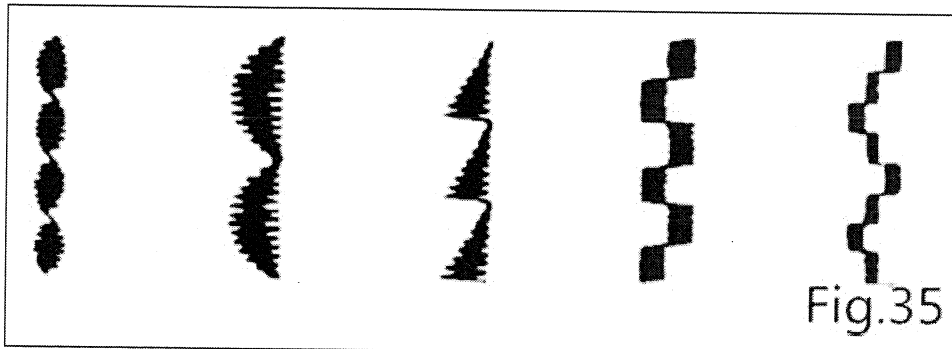

## 7. CLEANING AND OILING THE MACHINE

The machine should be cleaned periodically to remove lint and fluff, which may have accumulated around the working parts, a machine in continuous use should be oiled frequently.

## 22. MAINTENANCE OF THE MACHINE

You should protect your machine and clean it every day. Remove lint and fluff which may accumulate around the working parts like presser foot, needle plate, feed dog and rotating hook. A machine in continuous use should be oiled and cleaned frequently.

## 23. MAIN SPECIFICATION

The height of hand lifter presser foot: 6.35mm

Upper wheel: model V belt wheel 74mm

The height of work: 130mm

# PARTS LIST

# CONTENTS

COMPONENTS OF HOUSING .....	1
BOBBIN WINDER UPPER COVER COMPONENTS .....	3
STITCH-EMBROIDERY COMPONENTS .....	4
THREAD-HOOK COMPONENTS .....	7
MATERIAL -FEEDING COMPONENTS .....	7
DIFFERENTIAL,OIL COMPONENTS .....	8
COMPONENTS OF SWAYING NEEDLE .....	9
COMPONENTS OF SWAYING NEEDLE.....	10
COMPONENTS OF PRESSER FOOT.....	11
COMPONENTS OF NEEDLE DISTANCE OF REVERSAL STITCH	12
ACCESSARY .....	13
BELT COVER/THREAD-RUNNING COMPONENTS/BOBBIN WINDER/KNEE LIFTER ASSEMBLY.....	14

# COMPONENTS OF HOUSING

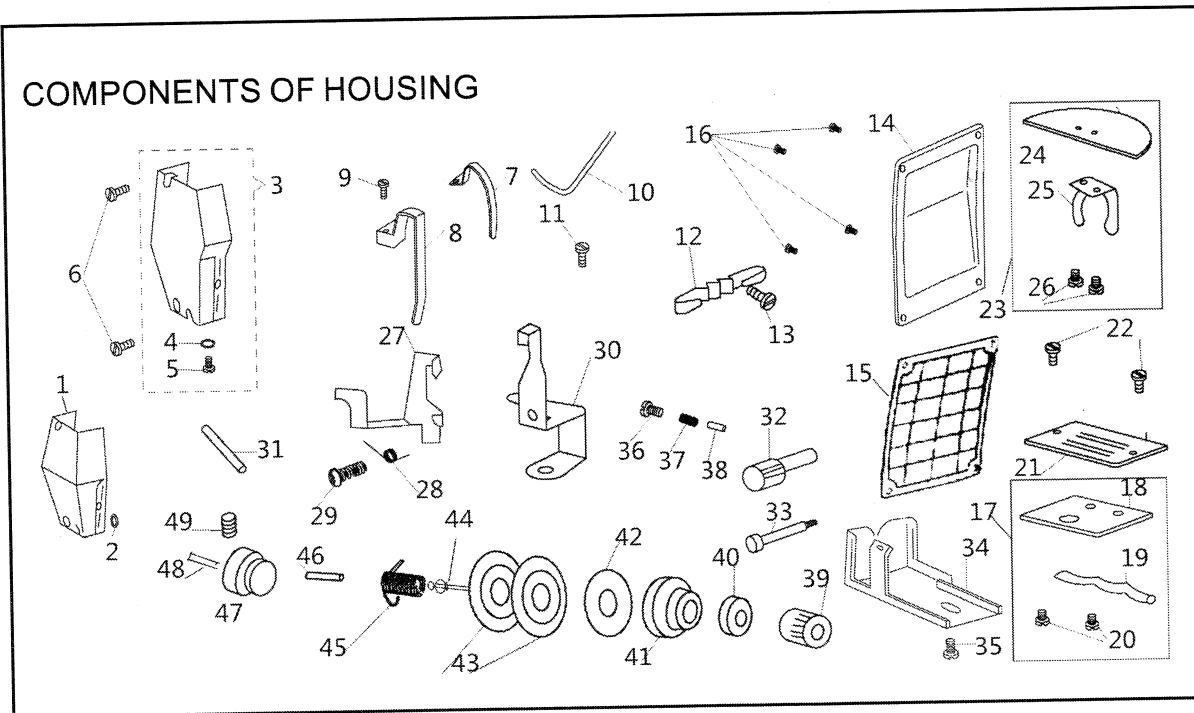

NO	PART NO.	CN2053R-1A	CN2053R-2A	QTY	DESCRIPTION
1	GR406/3-8	-	*	1	Panel components
2	GR232-8	-	*	1	Panel thread hook
3	GK158-8	*	-	1	Panel
4	GW242-8	*	-	1	Panel thread hook
5	GZ374-8	*	-	1	Panel thread hook needle
6	GS132-8	-	*	2	Panel screw
7	GS375-8	*	-	2	Panel screw
8	GK146-8	-	*	1	Stitch-scaff shield
9	GK161-8	*	-	1	Stitch- scaff shield
10	GS223-8	-	*	1	Stitch-scaff shield screw
11	GS379-8	*	-	1	Stitch-scaff shield screw
12	GR412-8	*	*	1	Double hole thread-running rack
13	GS139-8	*	*	1	3-eyelet hole thread hook screw
14	GR231-8	*	*	1	Thread-running rack
15	GS223-8	*	*	1	Thread-running rack screw
16	GK145-8	-	*	1	Back cover
17	GK160-8	*	-	1	Back cover
18	GS132-8	*	*	4	Back cover screw
19	GR476/4-8	*	*	1	Pushing plate components
20	GM132-8	*	*	1	Pushing plate
21	GW131-8	*	*	1	Pushing plate spring
22	GS133-8	*	*	2	Pushing plate spring screw
23	GM156-8	*	*	1	Needle plate
24	GS338-8	*	*	2	Needle plate screw
25	GR477/4-8	*	*	1	Inner cover plate components
26	GM130-8	*	*	1	Inner cover plate
27	GW130-8	*	*	1	Inner cover plate spring
28	GS255-8	*	*	2	Inner cover plate screw
29	GR373-8	*	*	1	Thread-releasing lever
30	GW135-8	*	*	1	Thread-releasing lever spring
31	GS148-8	*	*	1	Thread-releasing lever screw
32	GR397-8	*	*	1	Locating base of presser
33	GX180-8	*	*	1	Lower thread-running hook
34	GT150-8	-	*	1	Linear lock eccentric shield
35	GT159-8	*	*	1	Linear lock eccentric shield
36	GS264-8	*	*	1	Linear lock eccentric shield screw
37	GK130-8	*	*	1	Rotating shuttle shield
38	GS132-8	*	*	1	Rotating shuttle shield screw
39	GX191-8	*	*	1	Eccentric shield stress ploe
40	GW179-8	*	*	1	Eccentric shield stress spring
41	GS288-8	*	*	1	Stress spring screw
42	GL130-8	-	*	1	Thread-holding nut
43	GL176-8	*	-	1	Thread-holding nut

NO	PART NO.	CN2053R-1A	CN2053R-2A	QTY	DESCRIPTION
40	GR239-8	*	*	1	Thread-holding brake
41	GW133-8	-	*	1	Thread-holding spring
	GW208-8	*	-	1	Thread-holding spring
42	GR238-8	*	*	1	Thread-releasing plate
43	GR237-8	*	*	2	Thread-holding plate
44	GS145-8	*	*	1	Thread-holding screw
45	GW134-8	*	*	1	Stitch spring
46	GS146-8	*	*	1	Thread-holding fixing screw
47	GR372-8	*	*	1	Stitch-spring adjusting base
48	GX132-8	*	*	1	Thread-releasing needle
49	GS147-8	*	*	1	Thread-hold fixing screw



# BOBBIN WINDER UPPER COVER COMPONENTS

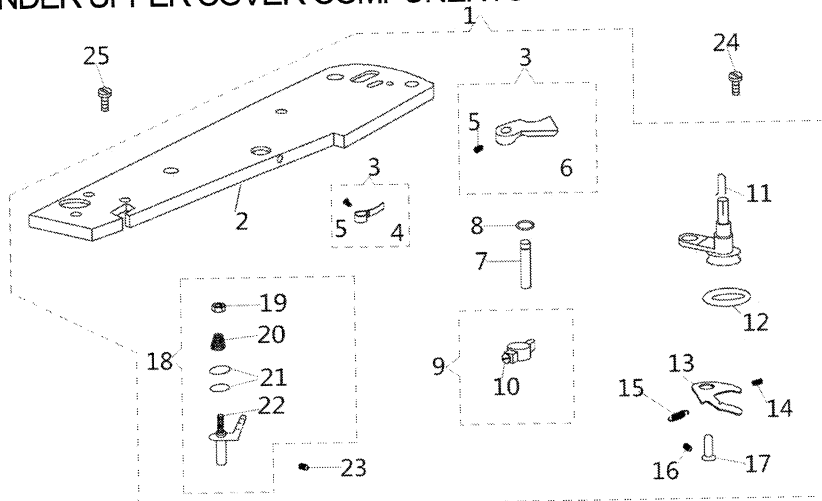

NO	PART NO.	CN2053R-1A	CN2053R-2A	QTY	DESCRIPTION
1	GR483/27-8	-	*	1	Upper cover components
	GR781/28-8	*	-	1	Upper cover components
2	GK148-8	-	*	1	Upper cover
	GK159-8	*	-	1	Upper cover
3	GR480/2-8	-	*	1	Volume adjusting plate components
4	GR377-8	-	*	1	Volume adjusting plate
5	GS273-8	-	*	1	Volume adjusting plate screw
6	GR726-8	*	-	1	Volume adjusting plate
7	GZ202-8	-	*	1	Volume adjusting spindle
	GZ246-8	*	-	1	Volume adjusting spindle
8	GO218-8	*	*	1	Washer
9	GR481/2-8	*	*	1	Locating block
10	GS222-8	*	*	1	Locating block set screw
11	GR405/8-8	-	*	1	Axis components
	GR780/9-8	*	-	1	Axis components
12	GO207-8	-	*	1	Rubber circule
	GO284-8	*	-	1	Rubber circule
13	GR375-8	*	*	1	Thread-winding swaying handle
14	GW173-8	*	*	1	Swaying handle presser spring
15	GW174-8	*	*	1	Swaying handle presser spring
16	GX182-8	*	*	1	Extension spring pin
17	GS272-8	-	*	1	Crank screw
	GX218-8	*	-	1	Crank screw
18	GR482/6-8	-	*	1	Upper thread-running plete
	GR778/6-8	*	-	1	Upper thread-running plate
19	GL162-8	-	*	1	Upper thread-running plate nut
	GL175-8	*	-	1	Upper thread-running plate nut
20	GW175-8	*	*	1	Upper thread-running plate spring
21	GR379-8	*	*	2	Upper thread-running pole
	GR403/2-8	*	*	2	Upper thread-running plate components
23	GS275-8	*	*	1	Fixing screw
24	GS142-8	-	*	1	Upper cover back screw
25	GS140-8	-	*	1	Upper cover set screw
	GS376-8	*	-	2	Upper covet screw

## STITCH-EMBROIDERY COMPONENTS

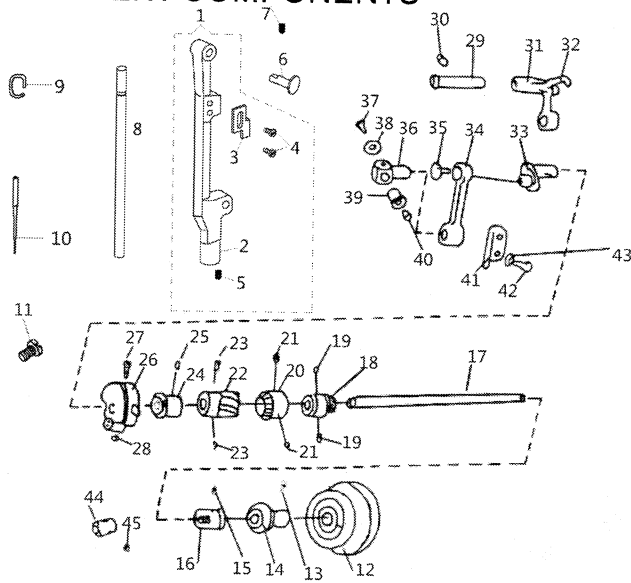

NO	PART NO.	CN2053R-1A	CN2053R-2A	QTY	DESCRIPTION
1	GR485/5-8	*	*	1	Swaying rack of needle staff components
2	GR251-8	*	*	1	Swaying rack of needle staff
3	GR255-8	*	*	1	Locating plate of needle staff
4	GS163-8	*	*	2	Locating plate screw
5	GS158-8	*	*	1	Eccentric pin screw of needle staff
6	GX143-8	*	*	1	Pin of swaying rack
7	GS164-8	*	*	1	Pin of swaying rack screw
8	GZ223-8	*	*	1	Needle bar
9	GR252-8	*	*	1	Thread-hook of needle staff
10	GV130-8	*	*	1	Needle
11	GS289-8	*	*	1	Needle lock screw
12	Gp142-8	*	*	1	Upper wheel lock screw
13	GS280-8	*	*	1	Sleeve screw
14	GO209-8	*	*	1	Sleeve of upper wheel
15	GS277-8	*	*	1	Back sleeve of upper shaft
16	GO208-8	*	*	1	Back sleeve of upper shaft
17	GZ203-8	-	*	1	Upper shaft
18	GZ248-8	*	-	1	Upper shaft
19	GT153-8	*	*	1	Cam of cloth-feeding
19	GS251-8	*	*	2	Cam of cloth-feeding screw
20	GC131-8	*	*	1	Arc-cone gear(upper shaft)
21	GS167-8	*	*	2	Screw or arc-cone gear
22	GC130-8	*	-	1	Spiral of gear of upper shaft
23	GC148-8	-	*	1	Spiral of gear of upper shaft
23	GS170-8	*	*	1	Screw of spiral gear
24	GO143-8	*	*	1	Front sleeve of upper shaft
25	GS169-8	*	*	1	Fastening screw of front sleeve
26	GH145-8	*	*	1	Stitch crank
27	GS168-8	*	*	1	Stitch crank screw
28	GS404-8	*	*	2	Crank fastening screw
29	GX144-8	*	*	1	Pin of swaying staff
30	GS147-8	*	*	1	Screw of swaying staff
31	GH141-8	*	*	1	Stitch-swaying staff
32	GH143-8	*	*	1	Stitch-staff
33	GH144-8	*	*	1	Crank of needle staff
34	GH140-8	*	*	1	Small connecting staff
35	GS166-8	*	*	1	Toothed screw
36	GR253-8	*	*	1	Connecting shaft
37	GS161-8	*	*	1	Pin-screw of needle
38	GO141-8	*	*	1	Pin-washer of connecting shaft
39	GZ142-8	*	*	1	Pin of connecting shaft
40	GS160-8	*	*	1	Pin-locking screw of connecting shaft



# THREAD-HOOK COMPONENTS

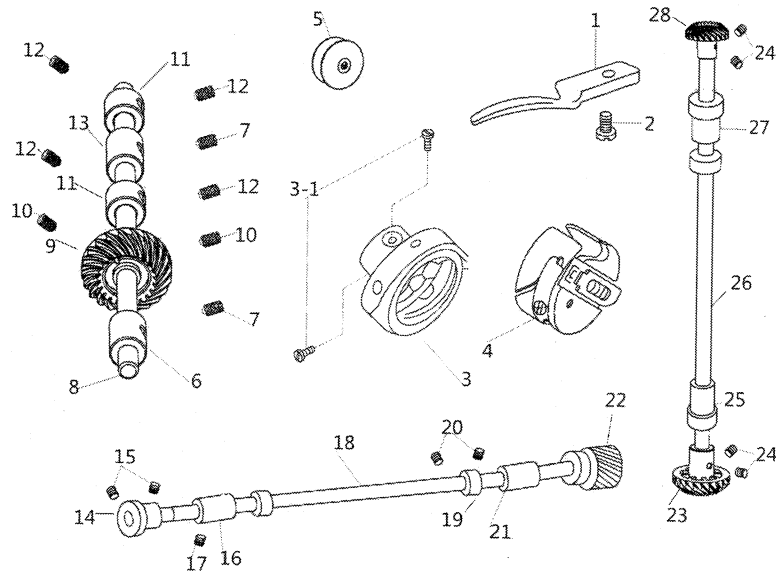

NO	PART NO.	CN2053R-1A	CN2053R-2A	QTY	DESCRIPTION
1	GR278-8	*	*	1	Locating plate of rotating shuttle
2	GS256-8	*	*	1	Screw of locating plate
3	GN130-8	*	*	1	Shuttle
4	GN131-8	*	*	1	Shuttle core
5	GN135-8	*	*	1	Rotating shuttle
6	GO163-8	*	*	1	Front sleeve of rotating shuttle shaft
7	GS201-8	*	*	2	Screw of front sleeve
8	GZ164-8	*	*	1	Rotating shuttle shaft
9	GC141-8	*	*	1	Screw arc-cone gear
10	GS167-8	*	*	2	Arc-cone gear of rotating shuttle shaft
11	GO164-8	*	*	2	Retainer of rotating shuttle shaft
12	GS202-8	*	*	4	Retainer screw
13	GO165-8	*	*	1	Back sleeve of rotating shuttle shaft
14	GC140-8	*	*	1	Arc-cone gear of lower shaft(left)
15	GS199-8	*	*	4	Screw of lower shaft
16	GO162-8	*	*	1	Front sleeve of lower shaft
17	GS147-8	*	*	2	Screw of arc-cone gear
18	GZ225-8	*	*	1	Lower shaft
19	GO232-8	*	*	1	Lower shaft retainer
20	GS299-8	*	*	4	Retainer screw of lower shaft
21	GO231-8	*	*	1	Back sleeve of lower shaft
22	GC151-8	*	*	1	Arc-cone gear of lower shaft(right)
23	GC152-8	*	*	1	Arc-cone gear of vertical shaft(lower)
24	GS199-8	*	*	4	Screw of differential gear
25	GO229-8	*	*	1	Lower sleeve of vertical shaft
26	GZ224-8	*	*	1	Vertical shaft
27	GO228-8	*	*	1	Upper sleeve of vertical shaft
28	GC150-8	*	*	1	Arc-cone gear of vertical shaft(upper)

# MATERIAL-FEEDING COMPONENTS

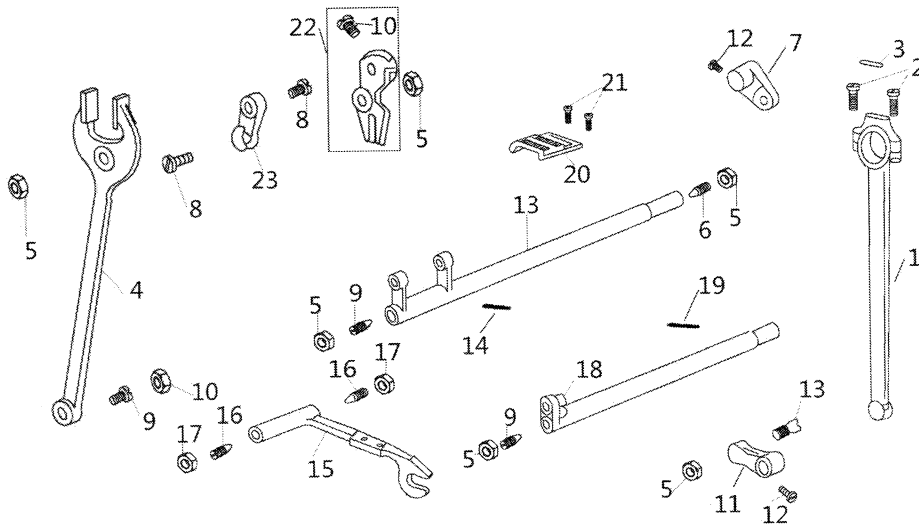

NO	PART NO.	CN2053R-1A	CN2053R-2A	QTY	DESCRIPTION
1	GR504/4-8	*	*	1	Toothed connecting bar components
2	GS142-8	*	*	2	Toothed connecting bar screw
3	GR268-8	*	*	1	Oil felt
4	GR267-8	*	*	1	Toothed fork
5	GC142-8	*	*	3	Small cone nut
6	GS188-8	*	*	3	Small cone screw
7	GH157-8	*	*	1	Connecting bar of needle distance base
8	GS283-8	*	*	1	Toothed fork small cone screw
9	GS284-8	*	*	1	Hinge Screw
10	GS263-8	*	*	1	Screw of needle distance base
11	GL142-8	*	*	1	Lifting rock shaft crank assembly
12	GX185-8	*	*	2	Crank screw of material-feeding tooth
13	GZ209-8	*	*	1	Cloth-feeding shaft
14	GR512-8	*	*	1	Cloth-feeding shaft oil level
15	GR265-8	*	*	1	Tooth rack
16	GS183-8	*	*	2	Pointed screw of tooth rack
17	GL140-8	*	*	2	Pointed nut of tooth rack
18	GZ151-8	*	*	1	Toothed shaft
19	GR1459-8	*	*	1	Toothed shaft oil level
20	GM160-8	*	*	1	Material-feeding shaft
21	GS194-8	*	*	1	Material-feeding shaft SCREW
22	GR336-8	-	*	1	Needle distance base
	GR734-8	*	-	1	Needle distance base

## DIFFERENTIAL, OIL COMPONENTS

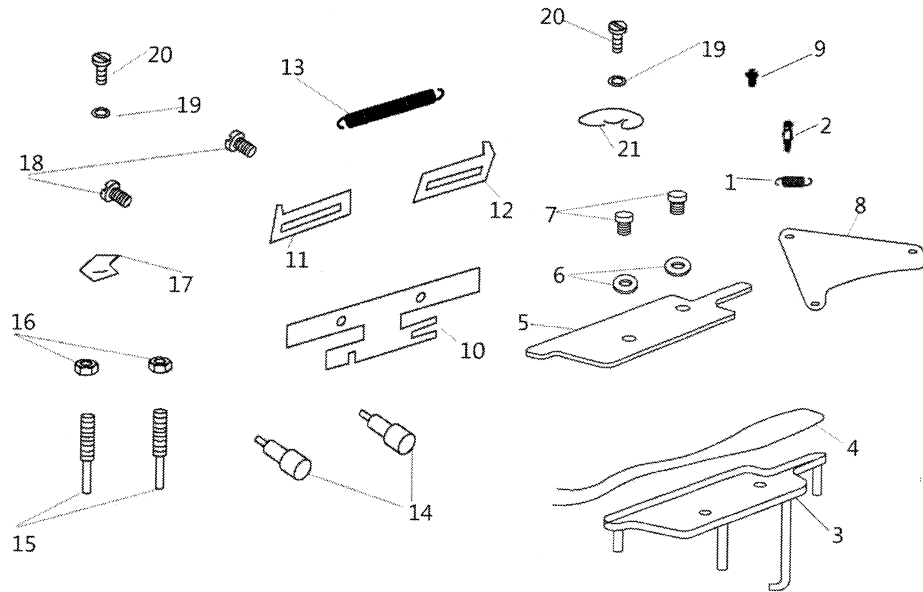

NO	PART NO.	CN2053R-1A	CN2053R-2A	QTY	DESCRIPTION
1	GW141-8	*	*	1	Spring for adjusting crank
2	GS212-8	*	*	1	Screw of extension spring
3	GR474/6-8	*	-	1	Oil tray
4	GR389-8	*	-	1	Oil gauze
5	GR388-8	*	-	1	Wheel of oil tray
6	GO217-8	*	-	2	Flat washer
7	GS132-8	*	-	2	Screw of oil tray
8	GR469-8	*	-	1	Oil tray set base
9	GS256-8	*	-	1	Screw of oil tray set base
10	GR294-8	*	*	1	Locating rack for needle distance
11	GR290-8	*	*	1	Locating rack for needle distance(A)
12	GR291-8	*	*	1	Locating rack for needle distance(B)
13	GW142-8	*	*	1	Extension spring of locating rack
14	GS253-8	-	*	2	Locating screw
	GS383-8	*	-	2	Locating screw
15	GS215-8	*	*	2	Adjusting screw of locating block
16	GL153-8	*	*	2	Adjusting nut of locating block
17	GR289-8	*	*	1	Locating block for needle block
18	GS213-8	*	*	2	Screw of locating block
19	GO174-8	*	*	2	Washer of locating block
20	GS256-8	*	*	2	Screw of locating block
21	GR289-8	*	*	1	Right locating block for needle distance

# COMPONENTS OF SWAYING NEEDLE

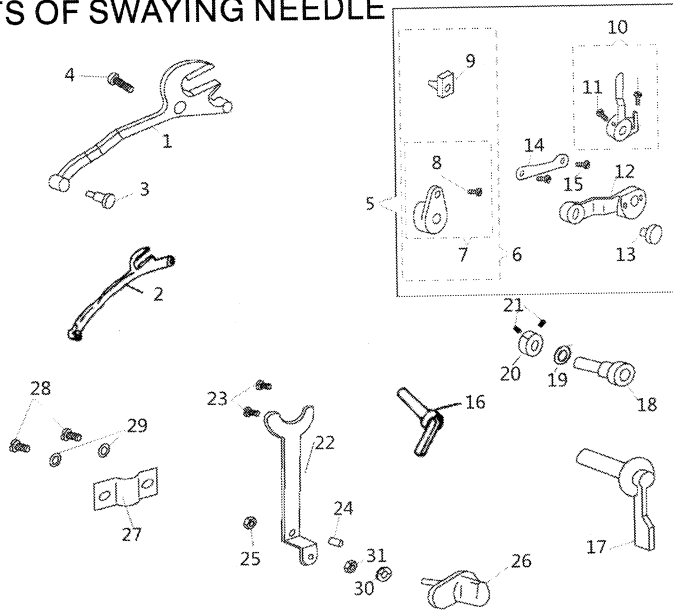

NO	PART NO.	CN2053R-1A	CN2053R-2A	QTY	DESCRIPTION
1	GR288-8	*	-	1	Fork of horizontal needle
2	GR457-8	-	*	1	Fork of horizontal needle
3	GX155-8	*	*	1	Eccentric pin of needle staff
4	GX291-8	*	*	1	Screw of sliding block
5	GR521/12-8	*	*	1	Locating block of swaying needle compone
6	GR519/3-8	*	*	1	Sliding block of swaying needle component
7	GR298-8	*	*	1	Guide base of swaying needle
8	GS185-8	*	*	1	Screw of guide base of swaying needle
9	GU140-8	*	*	1	Sliding block of swaying needle
10	GR292/2-8	*	*	1	Adjusting crank component
11	GS214-8	*	*	1	Screw of adjusting crank sleeve
12	GR296-8	*	-	1	Locating block of swaying needle
13	GR459-8	-	*	1	Locating block of swaying needle
14	GX154-8	*	*	1	Connecting pin of guide
15	GH178-8	*	*	1	Adjustable connecting bar
16	GS216-8	*	*	3	Connecting screw of differential connecting
17	GR392/2-8	-	*	1	Spanner of swaying needle component
18	GR731/2-8	*	-	1	Spanner of swaying needle component
19	GO179-8	-	*	1	Spanner sleeve
20	GO286-8	*	-	1	Spanner sleeve
21	GO211-8	*	*	1	Washer of spanner sleeve
22	GO178-8	*	*	1	Locating retainer of spanner
23	GR218-8	*	*	2	Screw of locating retainer of spanner
24	GR394-8	*	-	1	Adjusting rack
25	GS223-8	*	-	2	Screw
26	GS281-8	*	-	1	Locating pin of adjusting rack
27	GL163-8	*	-	1	Locating pin nut of adjusting rack
28	GR729-8	*	-	1	Handle component
29	GR395-8	*	-	1	Locating rack
30	GR468-8	*	-	2	Locating rack
31	GS273-8	*	-	1	Screw of locating rack
32	GO217-8	*	-	1	Washer of locating rack
33	GS224-8	*	-	1	Thumb stud nut
34	GR728-8	*	-	1	Thumb stud spring washer

## COMPONENTS OF SWAYING NEEDLE

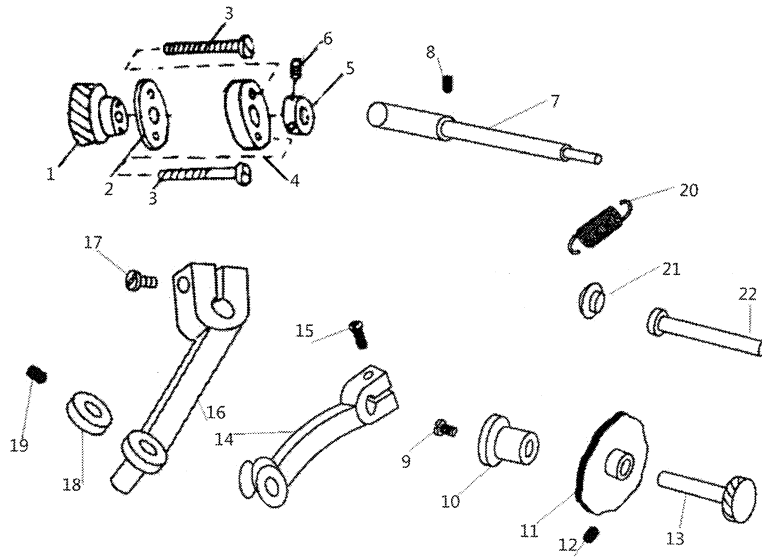

NO	PART NO.	CN2053R-1A	CN2053R-2A	QTY	DESCRIPTION
1	GC146-8	*	—	1	Gear of swaying needle
2	GO181-8	*	—	1	Eccentric retainer
3	GS221-8	*	—	1	Connecting screw of eccentric cam
4	GO213-8	*	—	2	Back retainer of eccentric cam
5	GO183-8	*	—	1	Retainer of swaying needle shaft
6	GS223-8	*	—	2	Screw of retainer of swaying shaft
7	GZ219-8	*	—	1	Swaying needle shaft
8	GS147-8	*	—	1	Screw of swaying needle shaft
9	GS166-8	—	*	1	Left-hand screw
10	GO226-8	—	*	1	Leaning gear sleeve
11	GR1314/2-8	—	*	1	Cam component
12	GS202-8	—	*	1	Sleeve screw of cam component
13	GC175-8	—	*	1	Leaning gear
14	GR458/3-8	—	*	1	Regulator fork drive lever component
15	GS285-8	—	*	1	Screw of drive lever
16	GR460/3-8	—	*	1	Following lever component
17	Gs020	—	*	1	Screw of following lever
18	GO164-8	—	*	1	Washer of following lever
19	GS202-8	—	*	1	Washer screw
20	GW178-8	—	*	1	Spring
21	Gr243	—	*	1	Rubber cap
22	GZ222-8	—	*	1	Following shaft



## COMPONENTS OF PRESSER FOOT

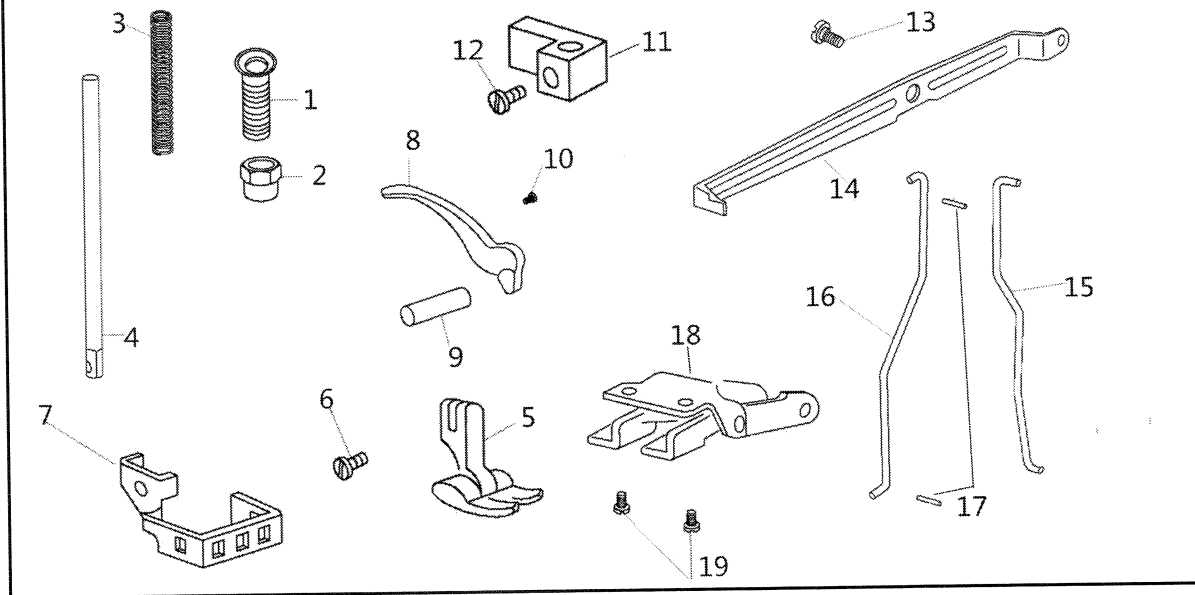

NO	PART NO.	CN2053R-1A	CN2053R-2A	QTY	DESCRIPTION
1	GS234-8	-	*	1	Screw for presser-adjusting
	GS384-8	*	-	1	Screw for presser-adjusting
2	GC178-8	*	-	1	Screw for presser-adjusting
3	GW153-8	*	*	1	Presser bar spring
4	GZ187-8	*	*	1	Presser bar
5	GR465/4-8	*	*	1	Presser foot component
6	GS231-8	*	*	1	Screw of presser foot
7	GR1000-8	*	*	1	Finger guard
8	GR322-8	-	*	1	Spanner
	GR733-8	*	-	1	Spanner
9	GX183-8	*	*	1	Spanner Pin
10	GS232-8	*	*	1	Spanner Pin screw
11	GR398-8	*	*	1	Presser bar bracket
12	GS232-8	*	*	1	Screw of bracket
13	GS235-8	*	*	1	Screw of presser foot lever
14	GZ204-8	*	*	1	Presser foot lever
15	GZ206-8	*	*	1	Rod of horizontal needle
16	GZ205-8	*	*	3	Rod of presser foot
17	GX184-8	*	*	1	Open-pin
18	GR328/10-8	*	*	1	Knee-control locating base component
19	GS236-8	*	*	1	Knee-control lever base screw

## COMPONENTS OF NEEDLE DISTANCE OF REVERSAL STITCH

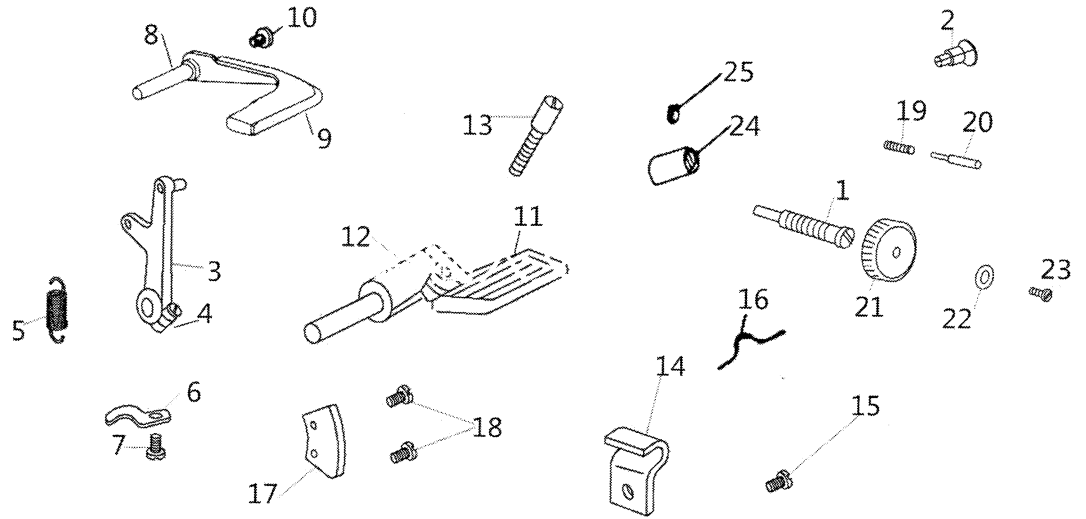

NO	PART NO.	CN2053R-1A	CN2053R-2A	QTY	DESCRIPTION
1	GS248-8	—	*	1	Adjusting screw for needle distance
2	GS413-8	*	—	1	Adjusting screw for needle distance
3	GX177-8	*	*	1	Needle distance base pin
4	GR342/2-8	*	*	1	Crank component
5	GS142-8	*	*	1	Crank screw
6	GW166-8	*	*	1	Restoring extension spring of reversal stitch
7	GR339-8	*	*	1	Spring hook
8	GS256-8	*	*	1	Screw of spring hook
9	GX178-8	—	*	1	Reversal stitch spanner shaft
10	GR338-8	—	*	1	Spanner of reversal stitch
11	GS247-8	—	*	1	Screw of spanner
11	GR735-8	*	—	1	Spanner of reversal stitch
12	GZ249-8	*	—	1	Reversal stitch spanner shaft
13	GS385-8	*	—	1	Regulating screw of reversal stitch
14	GR736-8	*	—	1	Regulating plate of reversal stitch
15	GS386-8	*	—	1	Screw of regulating plate
16	GW200-8	*	—	1	Regulating screw clamping spring
17	GR737-8	*	—	1	Feed reverse regulating indicating-dial
18	GS42	*	—	2	Screw of indicating-dial
19	GW167-8	*	*	1	Feed regulating stud lock pin spring
20	GX179-8	*	*	1	Feed regulating stud lock pin
21	GR399-8	—	*	1	Feed regulating dial
22	GR738-8	*	—	1	Feed regulating dial
23	GO380-8	*	—	1	Feed regulating dial stud washer
24	GS249-8	—	*	1	Feed regulating dial stud
25	GS387-8	*	—	1	Feed regulating dial stud
	GO204-8	*	*	1	Toothed nut
	GS201-8	*	*	1	Screw of toothed nut

# ACCESSARY

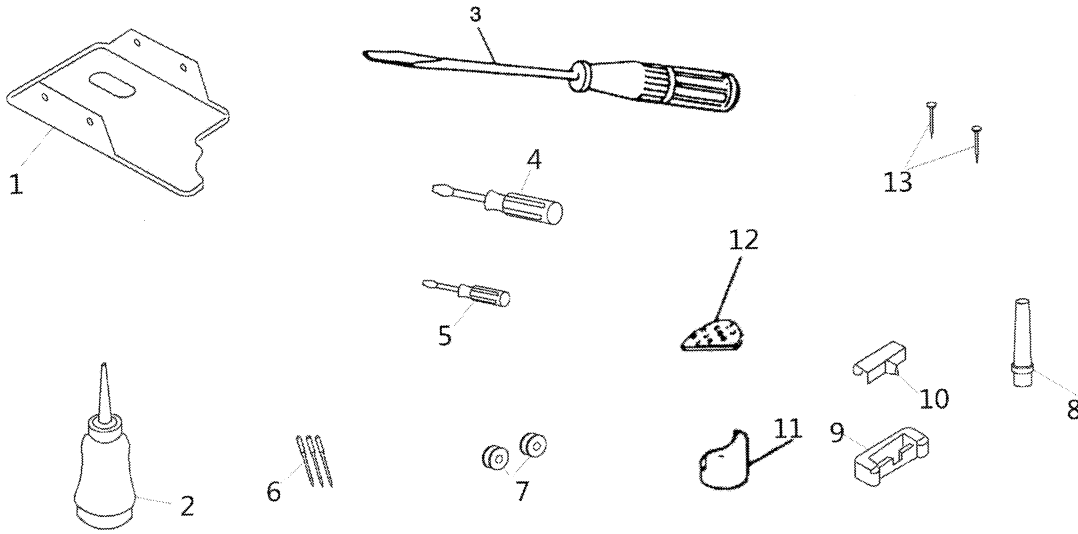

NO	PART NO.	CN2053R-1A	CN2053R-2A	QTY	DESCRIPTION
1	GR413-8	*	*	1	Oil reservoir
2	GF117-8	*	*	1	Oiler
3	GF114-8	*	*	1	Screwdriver(L)
4	GF115-8	*	*	1	Screwdriver(M)
5	GF116-8	*	*	1	Screwdriver(S)
6	GV130-8	*	*	1包	Needle
7	GN132-8	*	*	3	Bobbin
8	GBR211-8	*	*	1	Machine head pole
9	GR1593	*	*	1	Machine head hinge cushion rubber
10	GR696/2-8	*	*	1	Machine head hinge complete
11	GBX141-8	*	*	8	Oil reservoir nail
12	GBR204-8	*	*	2	Machine head cushion
13	GBR205-8	*	*	2	Machine head cushion

# BELT COVER/THREAD-RUNNING COMPONENTS/BOBBIN WINDER/KNEELIFTER ASSEMBLY

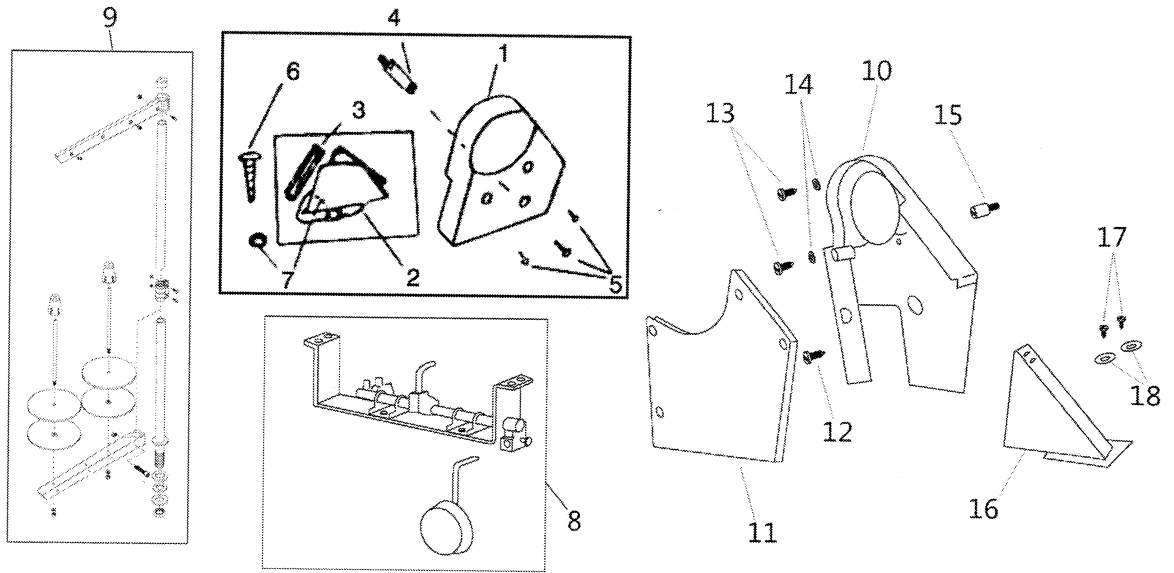

NO	PART NO.	CN2053R-1A	CN2053R-2A	QTY	DESCRIPTION
1	GR526-8	-	*	1	Hand wheel cover
2	GK155-8	-	*	1	Hand wheel back cover
3	GK156-8	-	*	1	Hand wheel back cover cap
4	GS654-8	-	*	1	Back cover pole
5	GS360-8	-	*	3	Pole screw
6	GBS204-8	-	*	2	Back cover wood screw
7	GBR210-8	*	*	2	Wood screw washer
8	GR1315/18-8	*	-	1	Knee lifter complete
9	GR760/25-8	*	*	1	Thread stand
10	GS3341-8	*	-	1	Belt gnard (upper)
11	GS2330-8	*	-	1	Belt gnard (upper) cover
12	GR3342-8	*	-	1	Belt gnard (upper) scren
13	GR3343-8	*	-	2	Belt gnard (upper) scren
14	GO2332-8	*	-	2	Belt gnard (upper) scren washer
15	GS3344-8	*	-	1	Belt gnard (upper) scren std
16	GR2332-8	*	-	1	Belt gnard (lower)
17	GS204-8	*	-	2	Belt gnard (lower) wood screw
18	GR210-8	*	-	2	Belt gnard (lower) wood screw washer

